

# AXOR<sup>®</sup>

**hansgrohe**

<b>DE</b>	Montageanleitung	<b>2</b>
<b>FR</b>	Instructions de montage	<b>2</b>
<b>EN</b>	assembly instructions	<b>3</b>
<b>IT</b>	Istruzioni per Installazione	<b>3</b>
<b>ES</b>	Instrucciones de montaje	<b>4</b>
<b>NL</b>	Handleiding	<b>4</b>
<b>DK</b>	Monteringsvejledning	<b>5</b>
<b>PT</b>	Manual de Instalação	<b>5</b>
<b>PL</b>	Instrukcja montażu	<b>6</b>
<b>CS</b>	Montážní návod	<b>6</b>
<b>SK</b>	Montážny návod	<b>7</b>
<b>ZH</b>	组装说明	<b>7</b>
<b>RU</b>	Инструкция по монтажу	<b>8</b>
<b>HU</b>	Szerelési útmutató	<b>9</b>
<b>FI</b>	Asennusohje	<b>9</b>
<b>SV</b>	Monteringsanvisning	<b>10</b>
<b>LT</b>	Montavimo instrukcijos	<b>10</b>
<b>HR</b>	Uputstva za instalaciju	<b>11</b>
<b>TR</b>	Montaj kılavuzu	<b>11</b>
<b>RO</b>	Instrucțiuni de montare	<b>12</b>
<b>EL</b>	Οδηγία συναρμολόγησης	<b>12</b>
<b>SL</b>	Navodila za montažo	<b>13</b>
<b>ET</b>	Paigaldusjuhend	<b>13</b>
<b>LV</b>	Montāžas instrukcija	<b>14</b>
<b>SR</b>	Uputstvo za montažu	<b>14</b>
<b>NO</b>	Montasjeveiledning	<b>15</b>
<b>BG</b>	Ръководство за монтаж	<b>15</b>
<b>SQ</b>	Udhëzime rreth montimit	<b>16</b>
<b>AR</b>	تعليمات التجميع	<b>16</b>

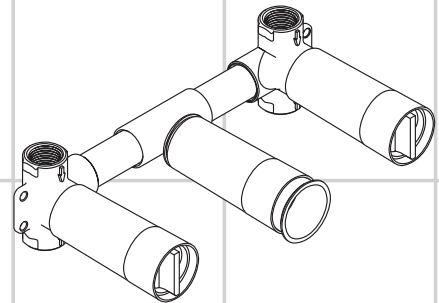

10303180



## **Indicaciones de seguridad**

- ⚠ Durante el montaje deben utilizarse guantes para evitar heridas por aplastamiento o corte.
- ⚠ Grandes diferencias de presión en servicio entre agua fría y agua caliente deben equilibrarse.

## **Indicaciones para el montaje**

- Antes del montaje se debe examinar el producto contra daños de transporte. Después de la instalación so se reconoce ningún daño de transporte o de superficie.
- El grifo tiene que ser instalado, probado y testado, según las normas en vigor.
- El grifo debe ser instalado con aislamiento y desacoplamiento acústico.

## **Descripción de símbolos**



No utilizar silicona que contiene ácido acético!



Área refuerzo necesario de la pared

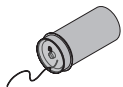

Hilo de teflón



**Ejemplos de montaje** (ver página 19)

La altura de montaje debe adaptarse individualmente al lavabo.

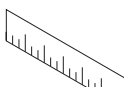

**Dimensiones** (ver página 18)



**Repuestos** (ver página 18)

**Opcional** (ver página 18)

no incluido en el suministro



Tira impermeabilizante #96383000

Prolongación 25 mm #96529000

Prolongación 25 mm #95413000



**Marca de verificación** (ver página 36)

## **Montaje**

### **ver página 17**

## **Veiligheidsinstructies**

- ⚠ Bij de montage moeten ter voorkoming van knel- en snijwonden handschoenen worden gedragen.
- ⚠ Grote drukverschillen tussen de koud- en warmwatertoevoer dienen vermeden te worden.

## **Montage-instructies**

- Vóór de montage moet het product gecontroleerd worden op transportschade. Na de inbouw wordt geen transport- of oppervlakteschade meer aanvaard.
- Leidingen doorspoelen volgens Norm. De mengkraan vervolgens monteren en controleren!
- De armatuur moet geïsoleerd en geluidsontkoppeld gemonteerd worden.

## **Symboolbeschrijving**



Gebruik geen zuurhoudende silicone!



Wandversterking noodzakelijk voor montage

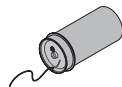

Teflondraad



**Montagevoorbeelden** (zie blz. 19)

De montagehoogte moet individueel aan de wastafel worden aangepast.

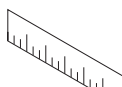

**Maten** (zie blz. 18)



**Service onderdelen** (zie blz. 18)

**Toebehoren** (zie blz. 18)

behoort niet tot het leveringspakket



dichtmanchet #96383000

Verlengstuk 25 mm #96529000

Verlengstuk 25 mm #95413000



**Keurmerk** (zie blz. 36)

## **Montage**

### **zie blz. 17**

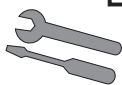

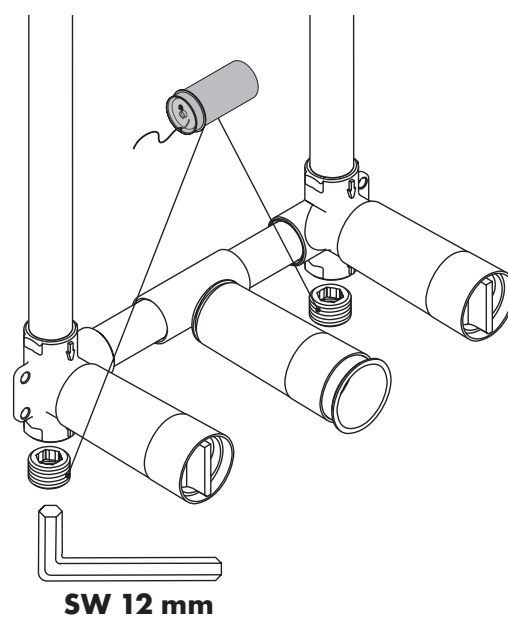
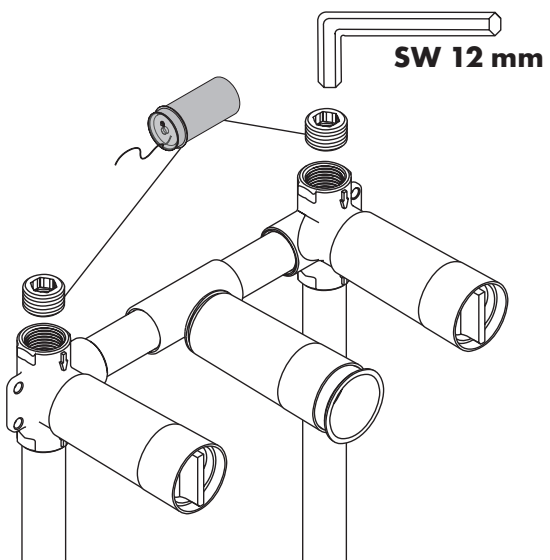
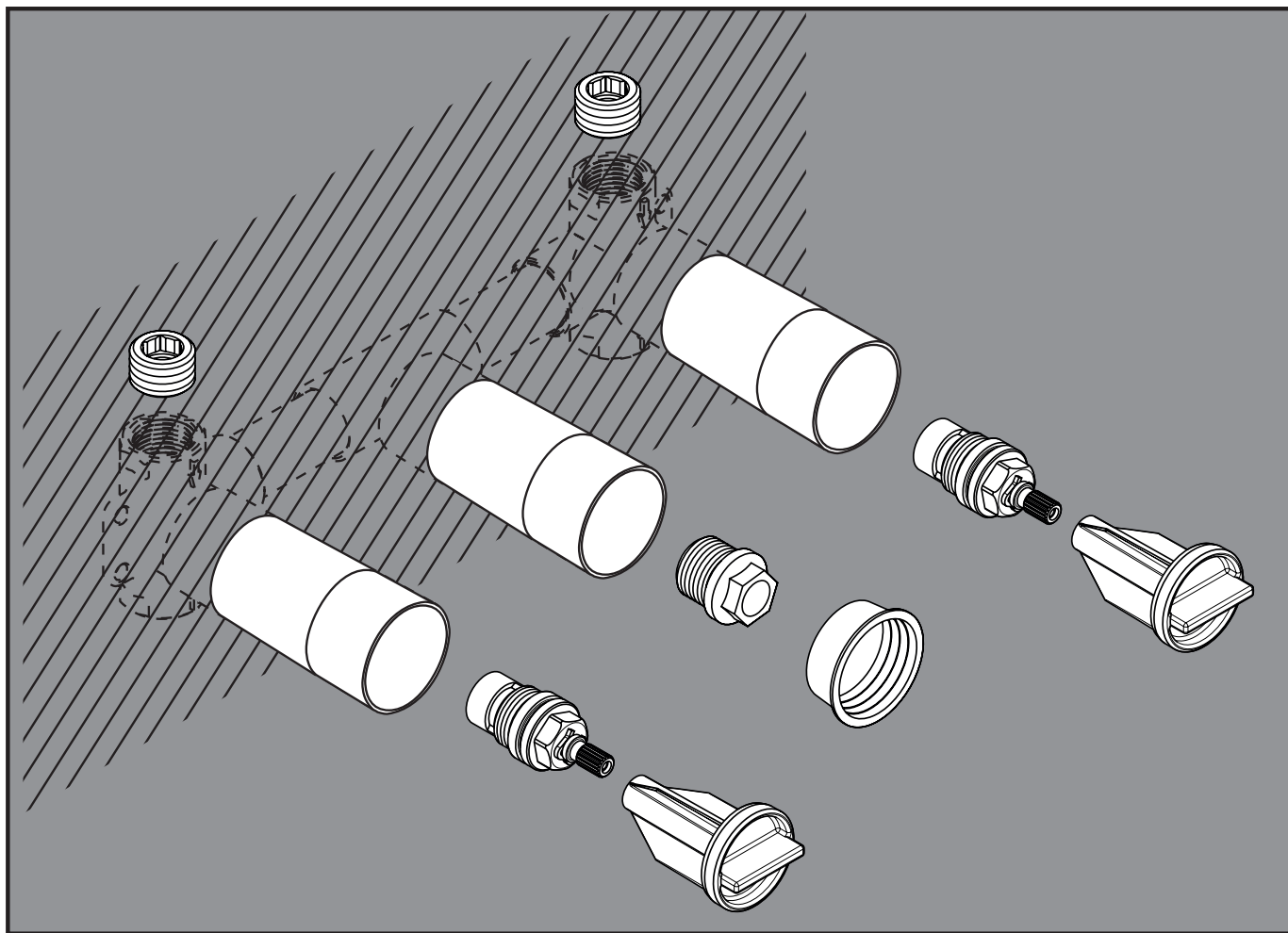
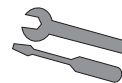

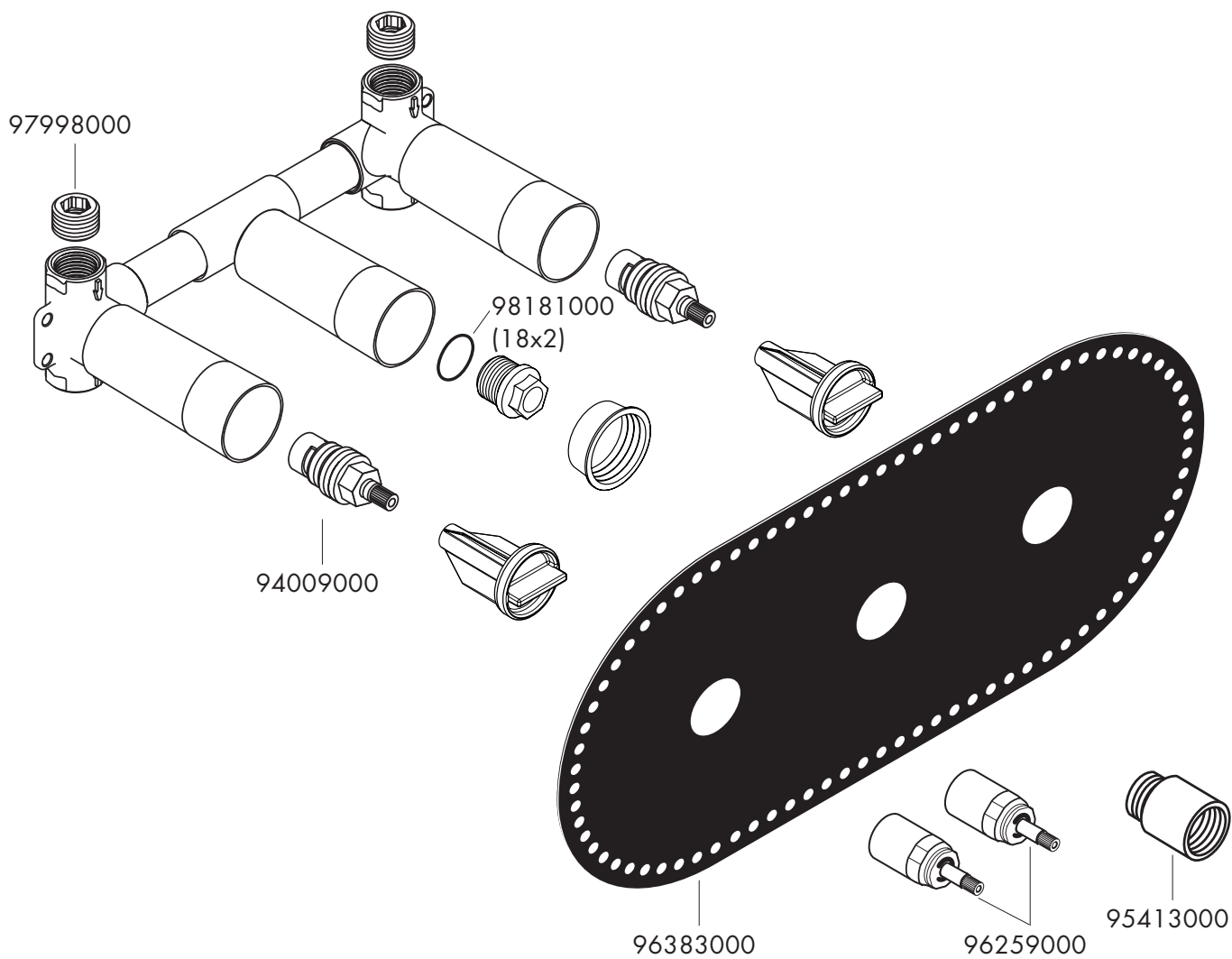
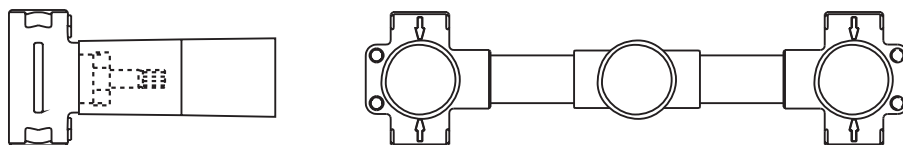
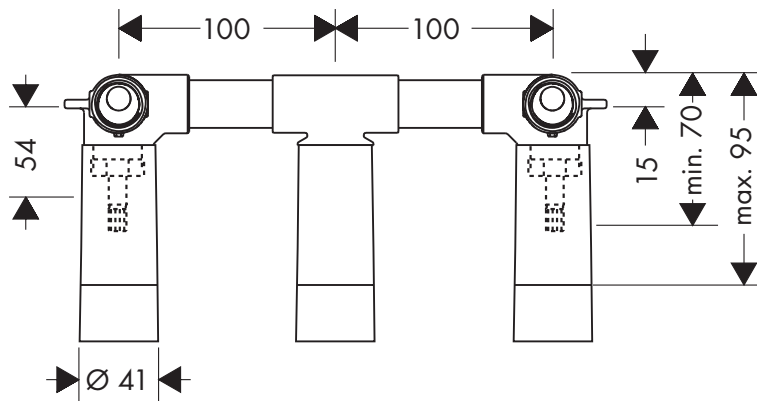
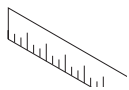



**Starck 10313000**

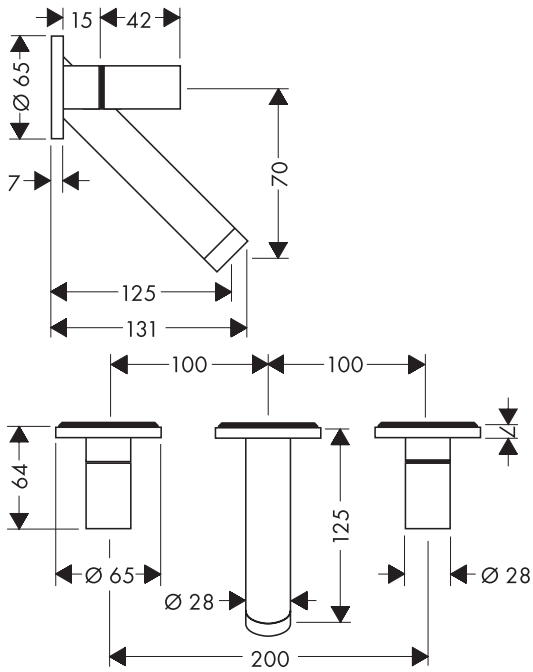
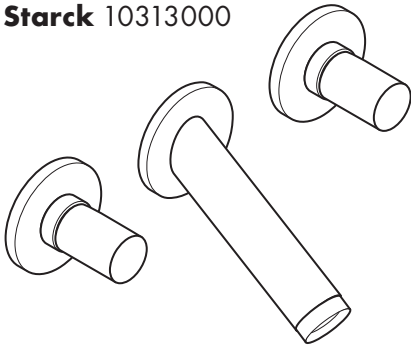

**Montreux 16532XXX**

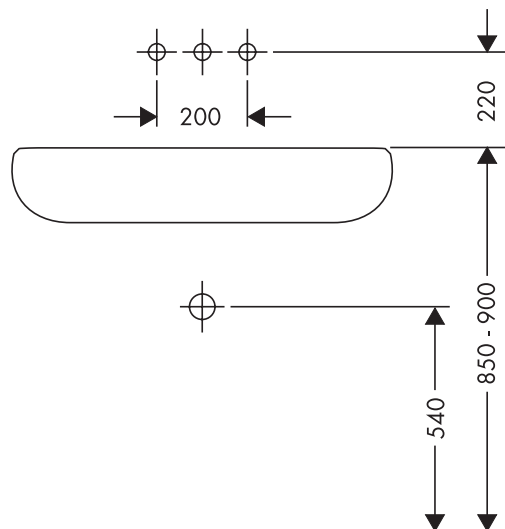
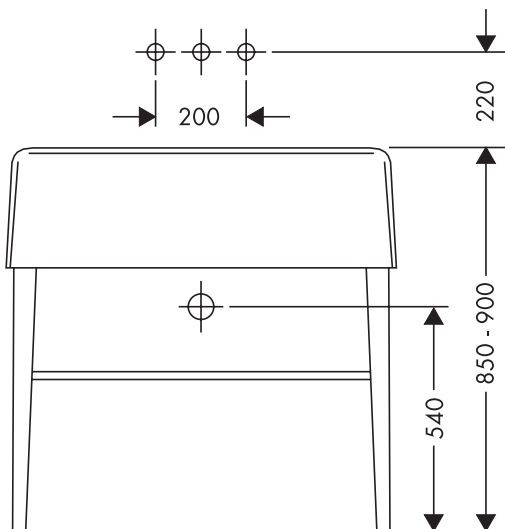
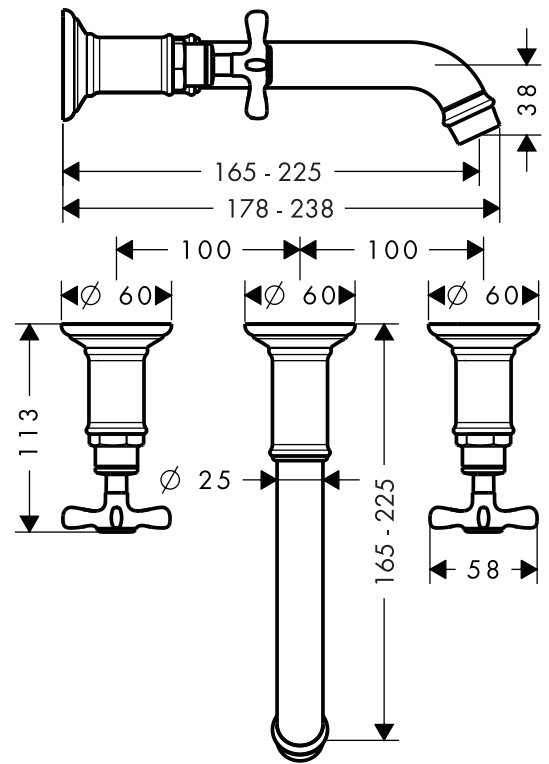
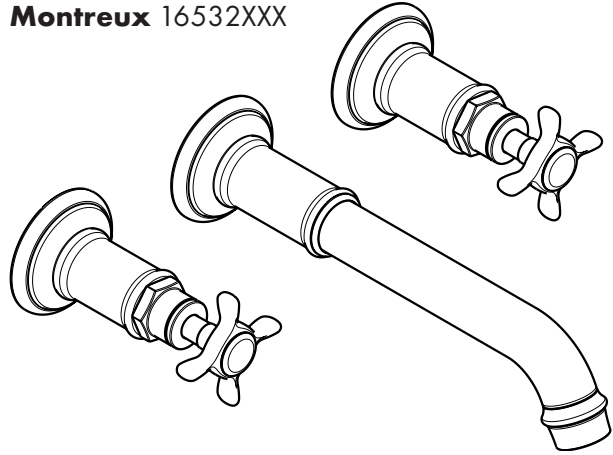



**Urquiola 11042000**

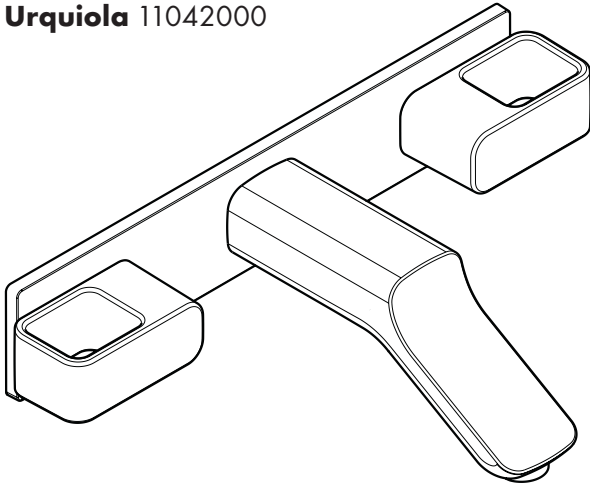

**Urquiola 11043000**

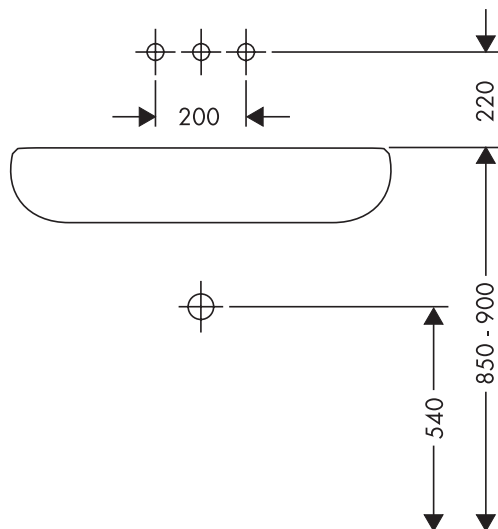
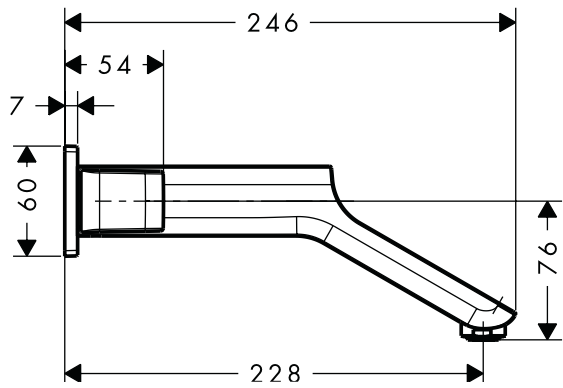
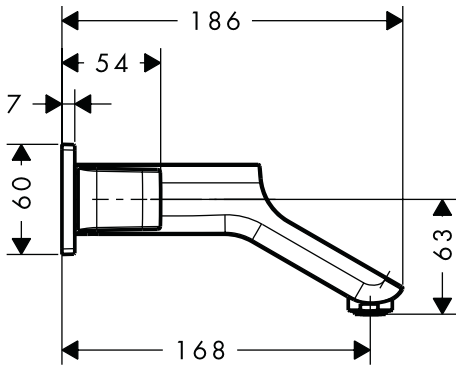
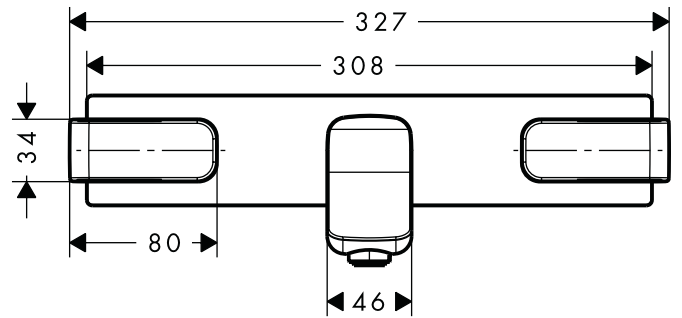
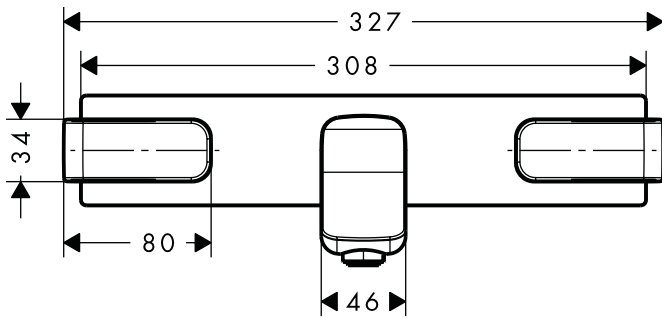
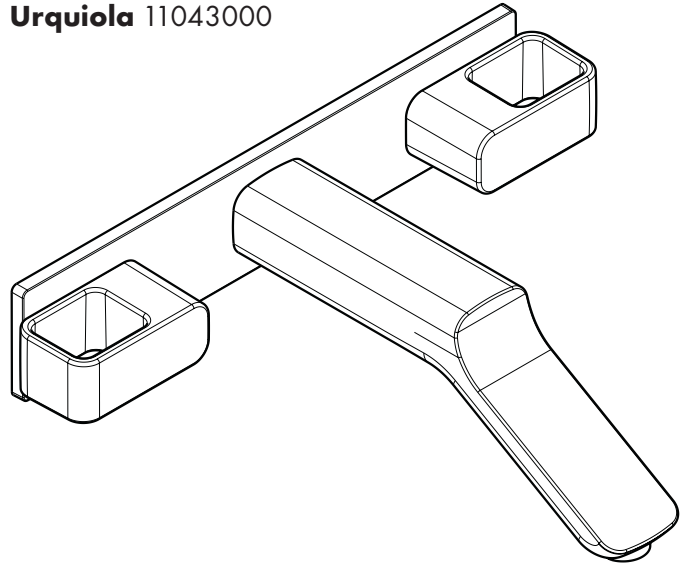



**Citterio M 34215000**

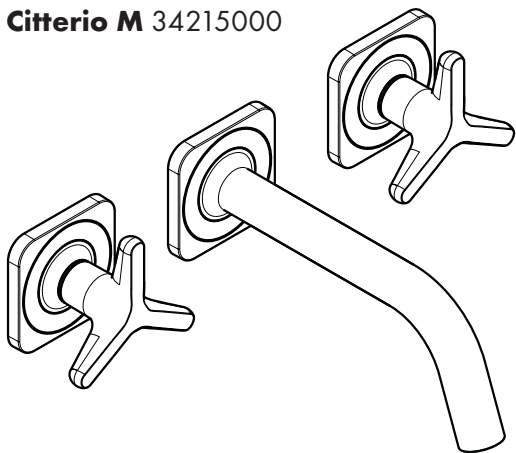

**Citterio M 34217000**

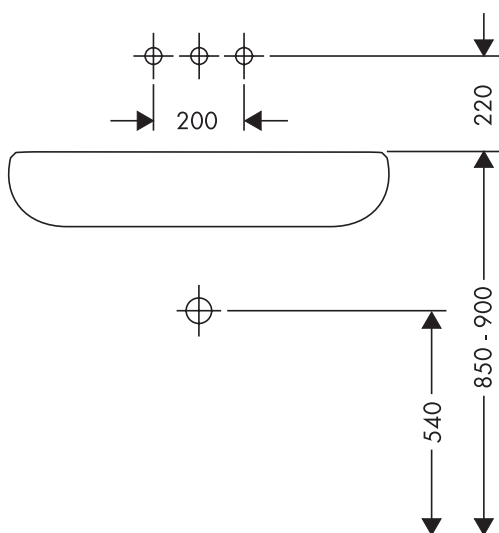
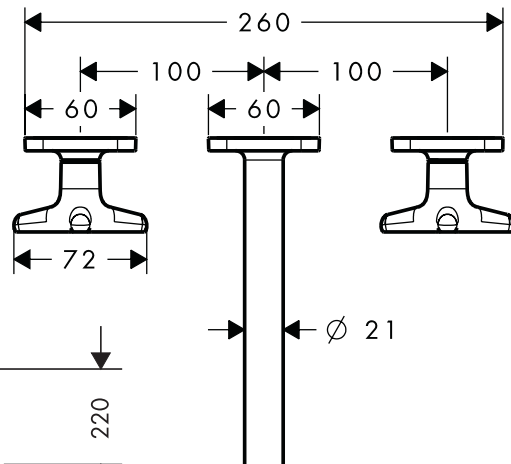
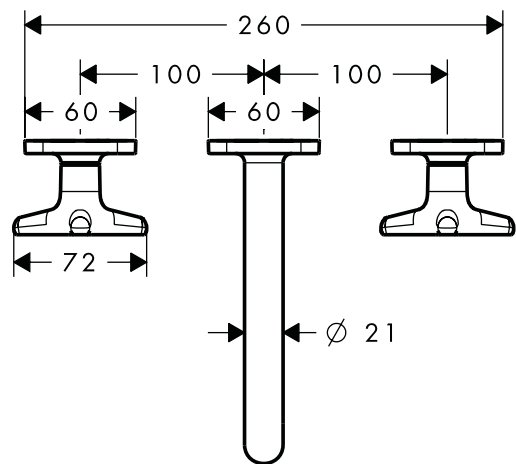
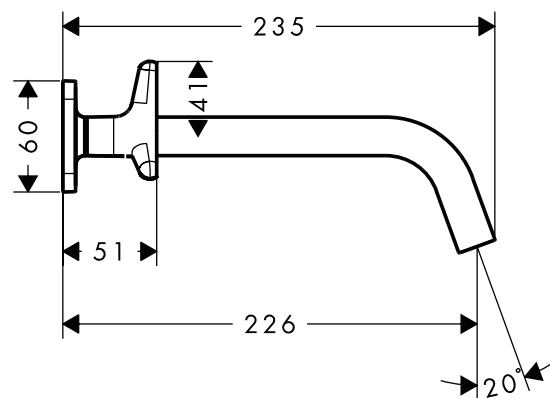
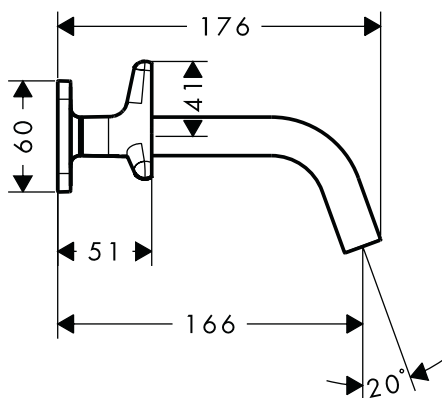
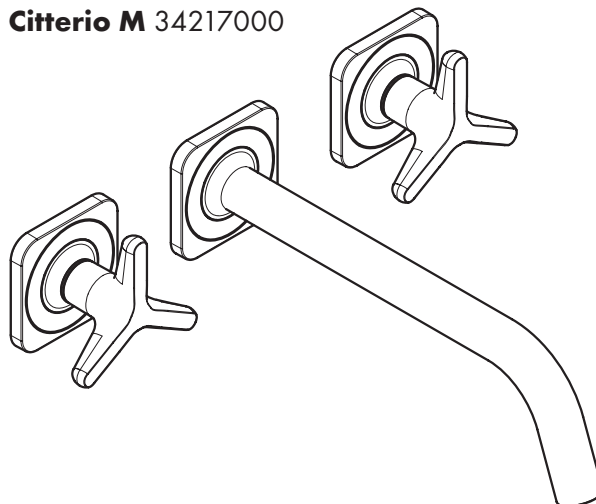



**Citterio M 34313000**

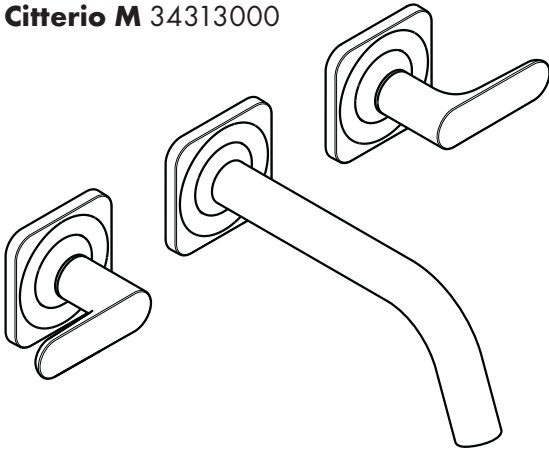

**Citterio M 34315000**

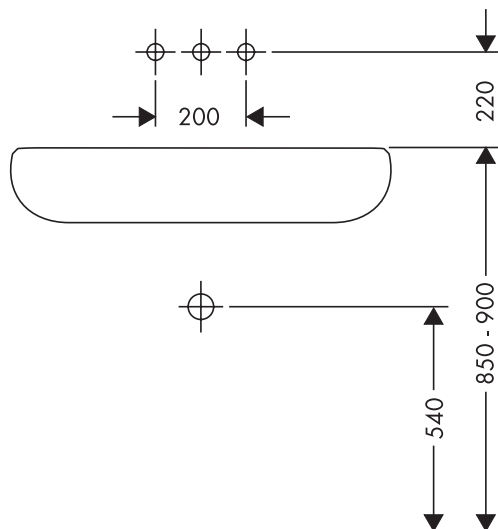
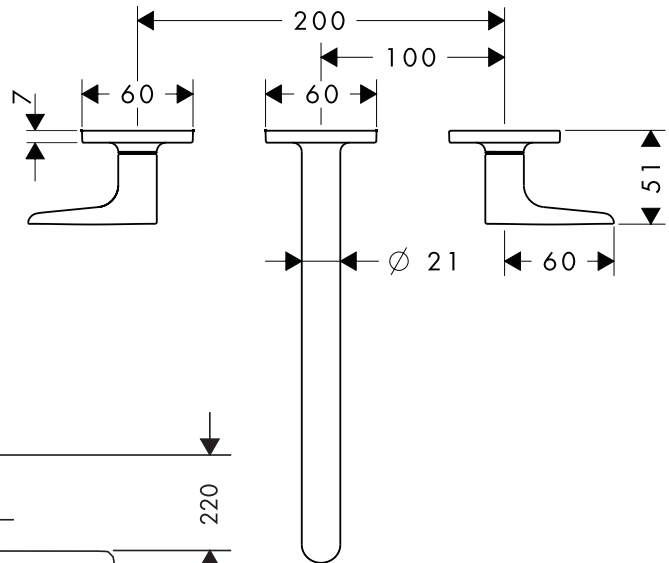
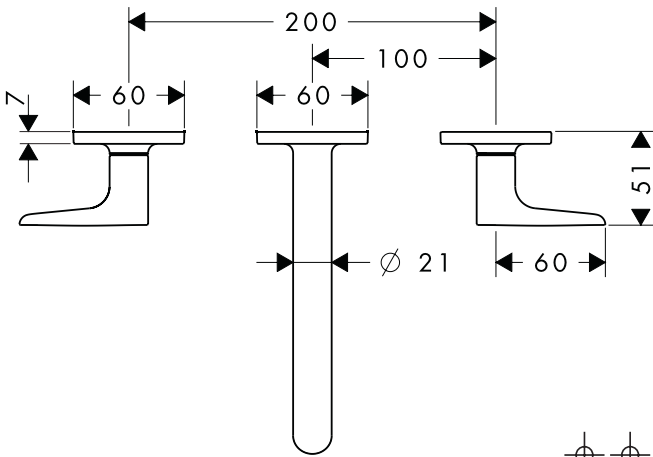
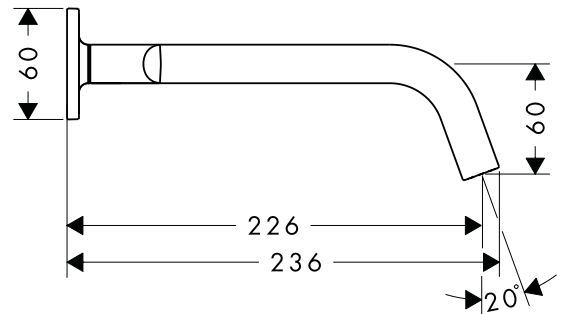
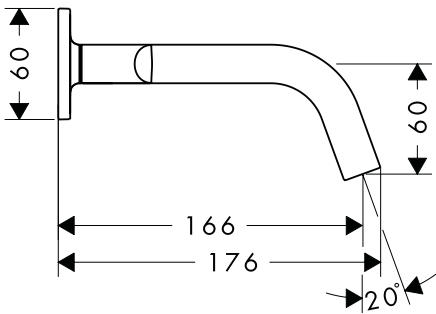
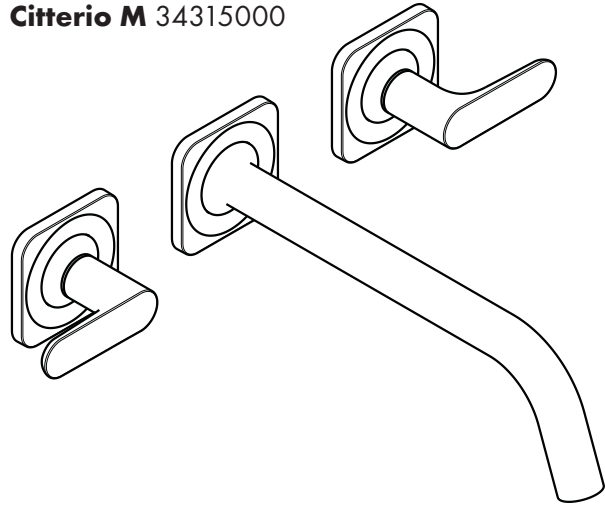



**Citterio M 34314000**

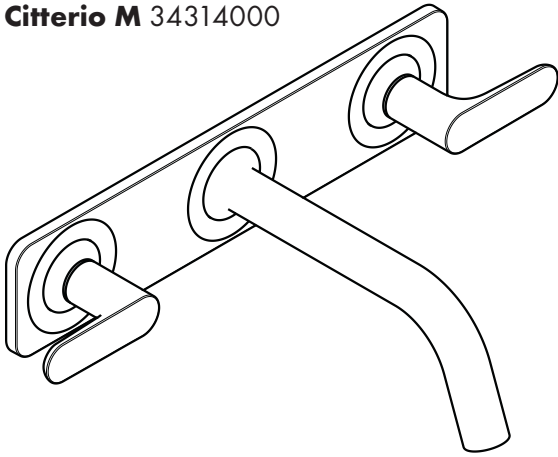

**Citterio M 34316000**

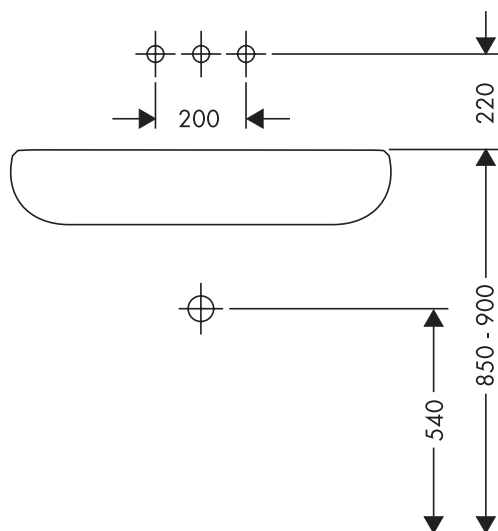
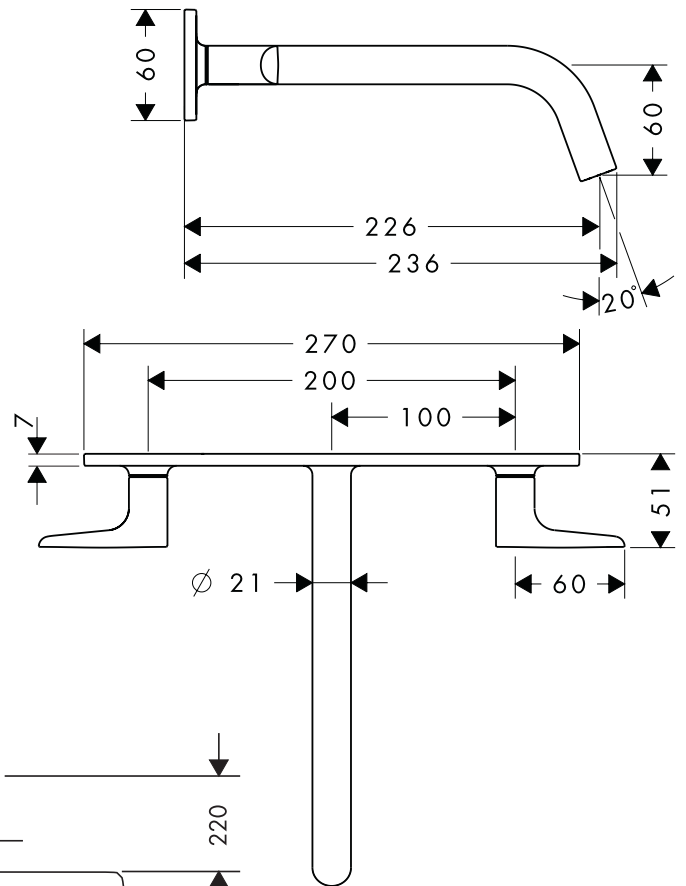
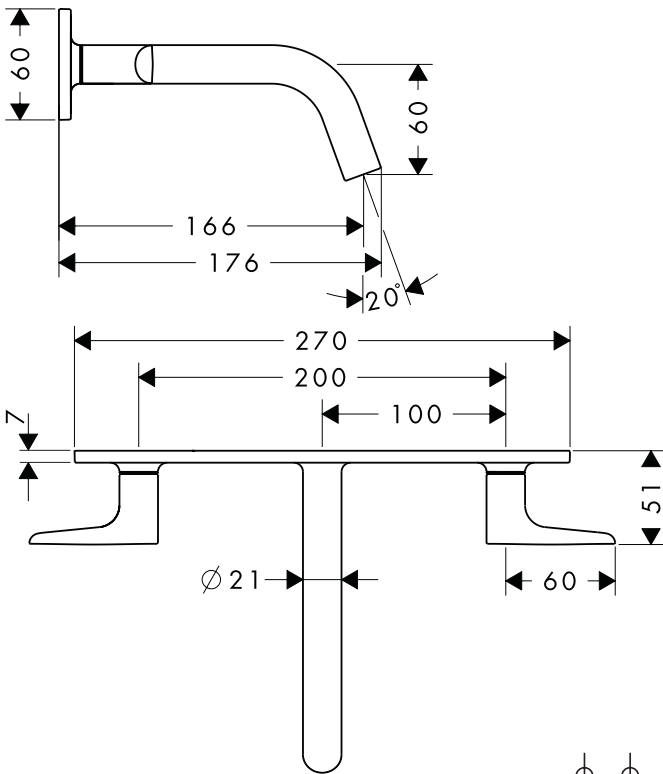
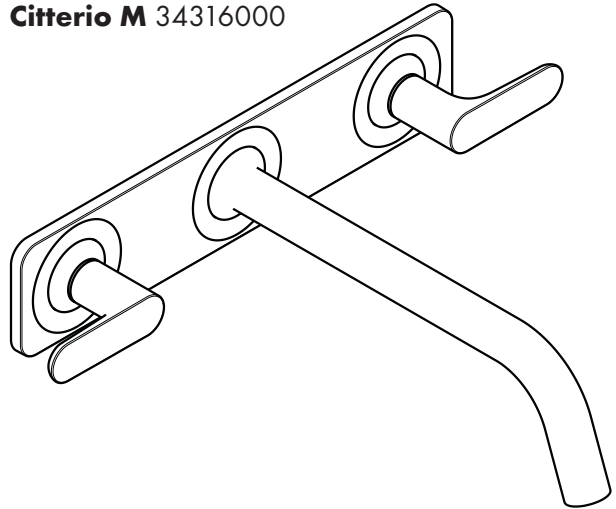



**Citterio 39314000**

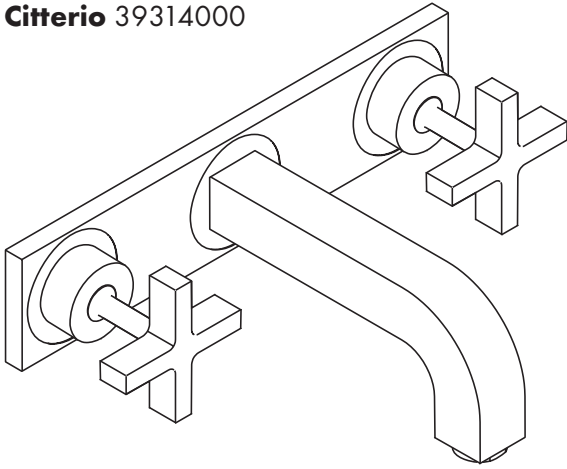

**Citterio 39144000**

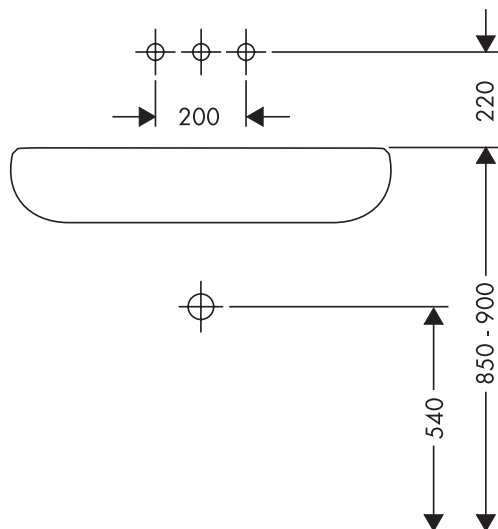
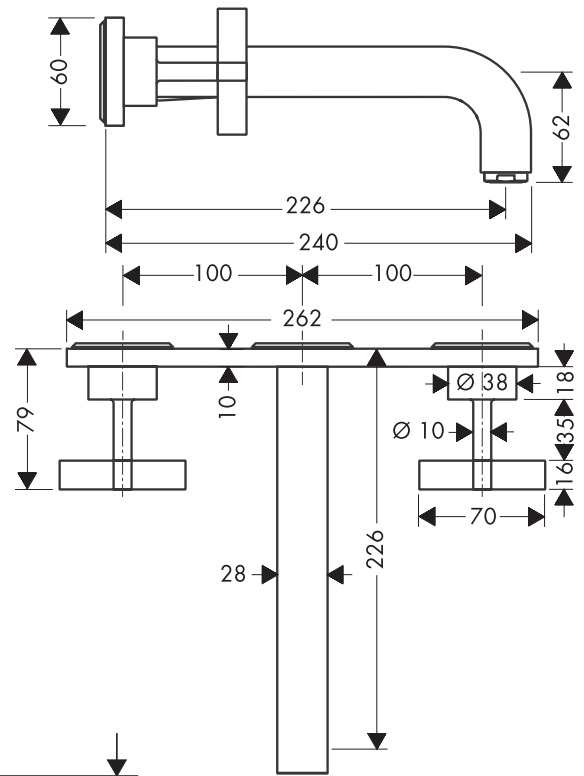
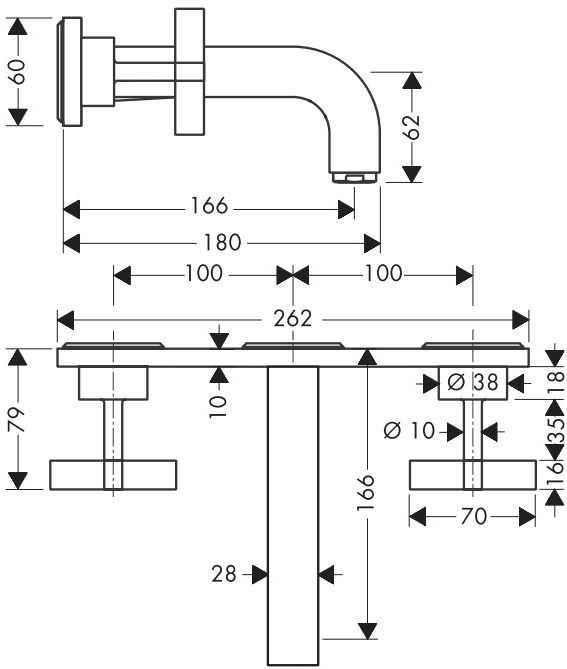
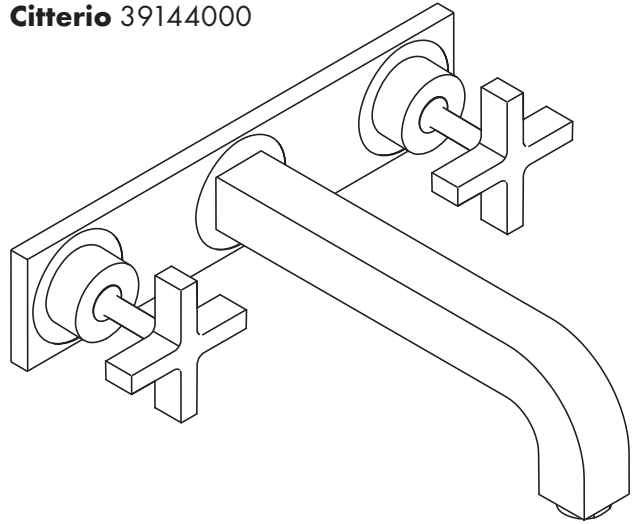



**Citterio 39313000**

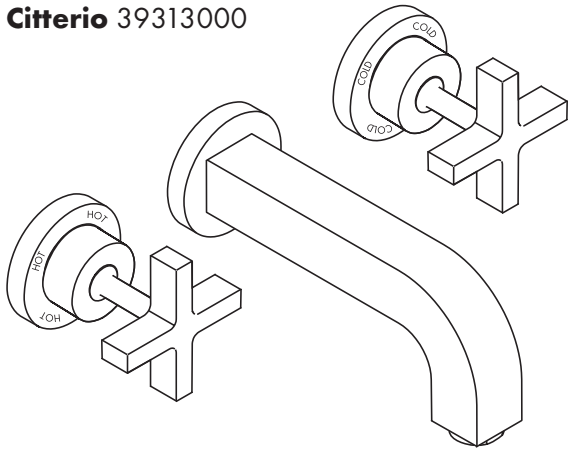

**Citterio 39143000**

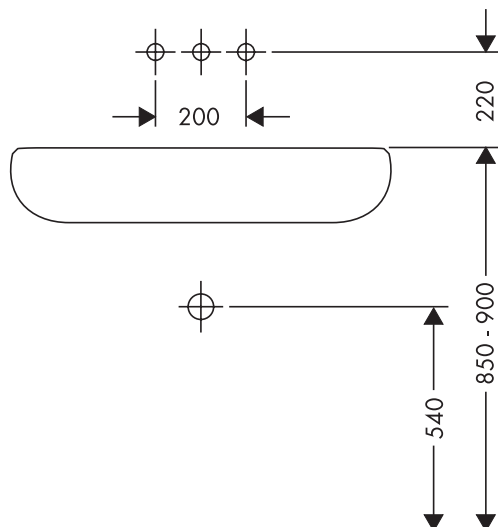
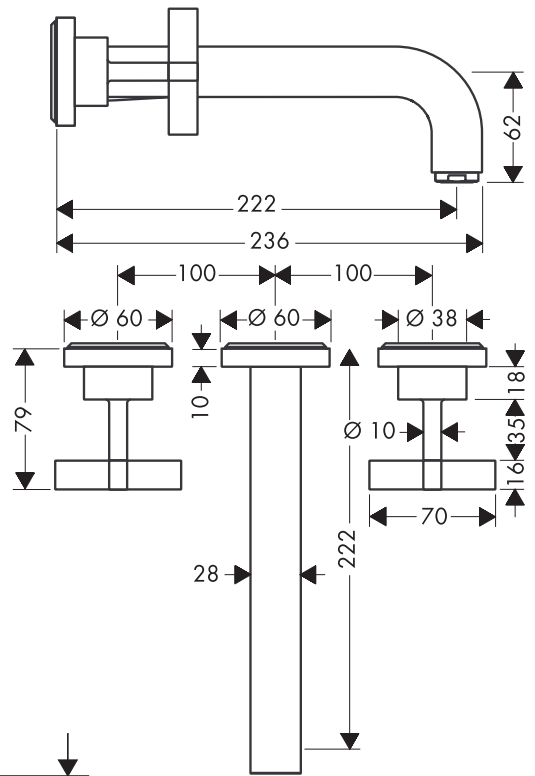
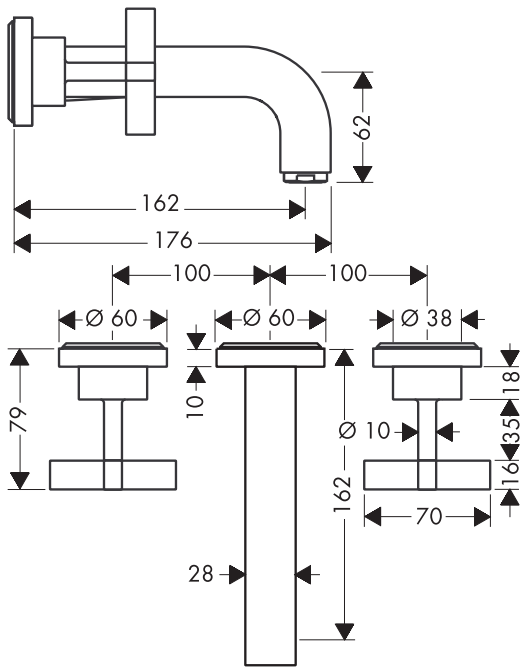
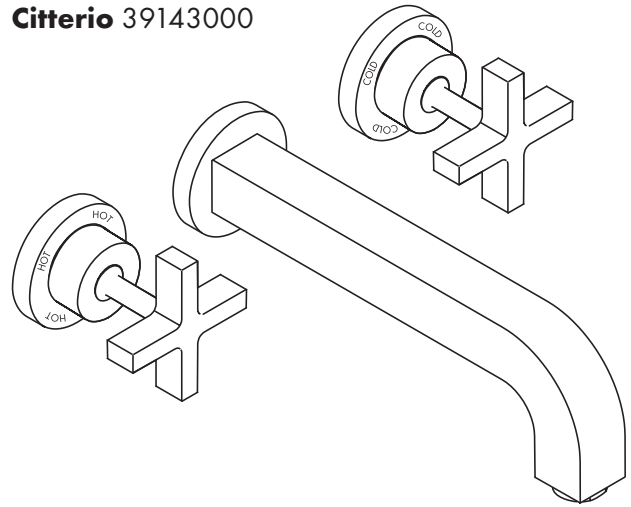



**Citterio 39316000**

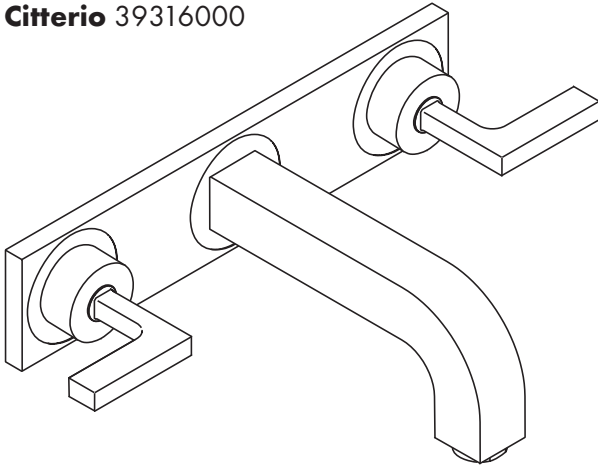

**Citterio 39148000**

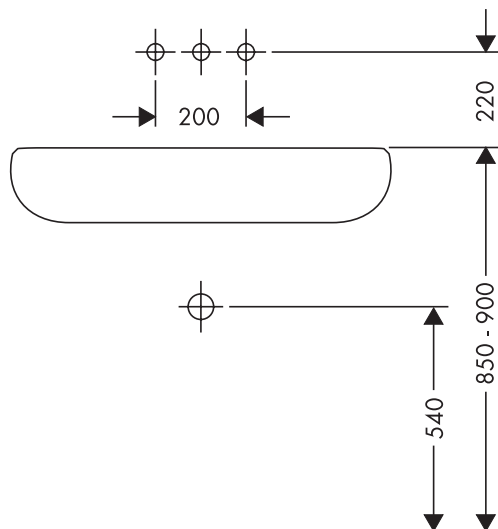
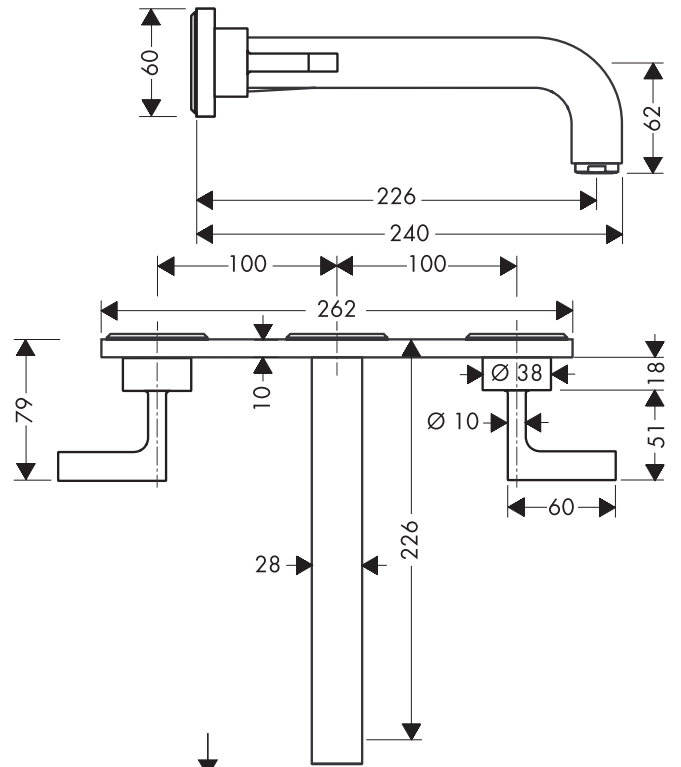
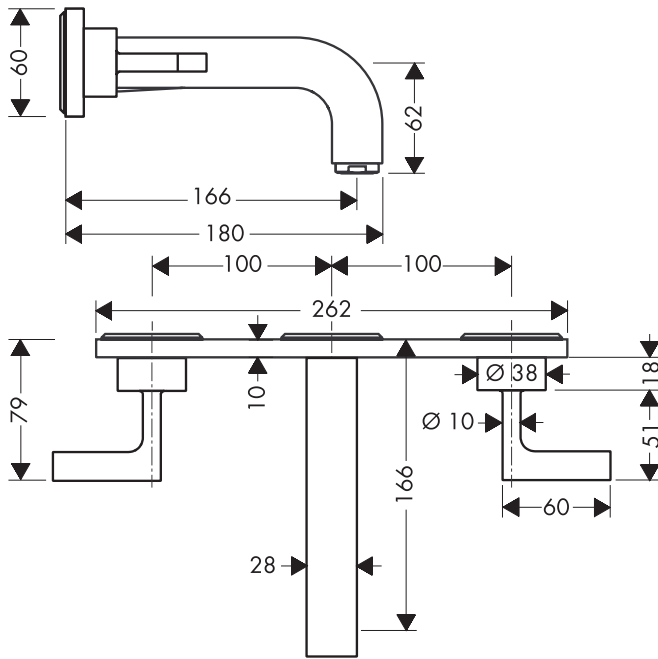
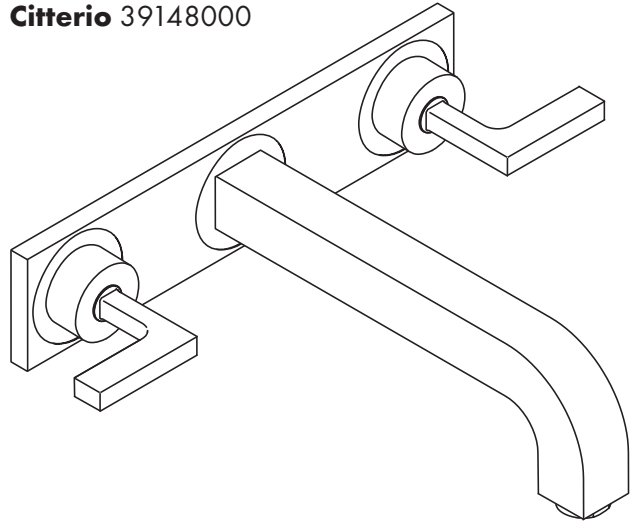



**Citterio 39315000**

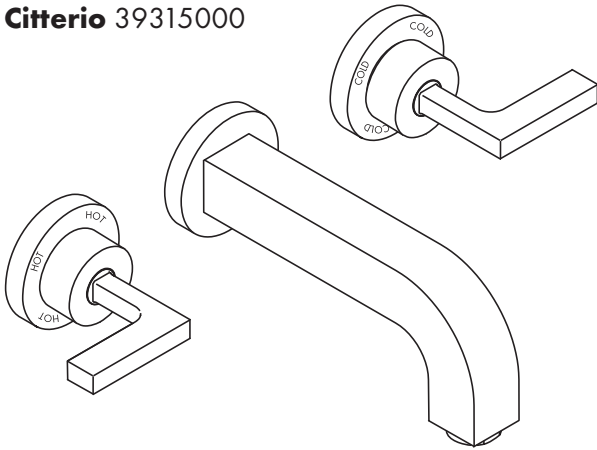

**Citterio 39147000**

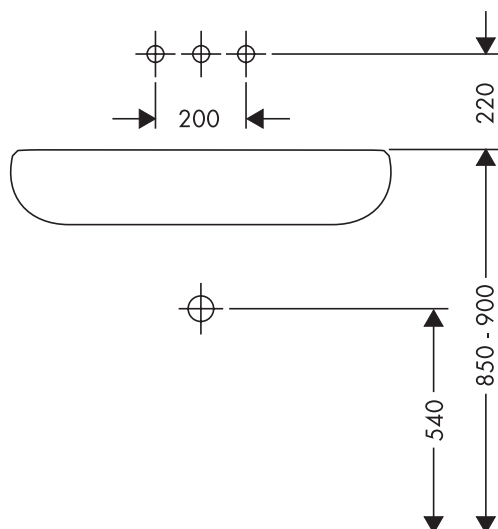
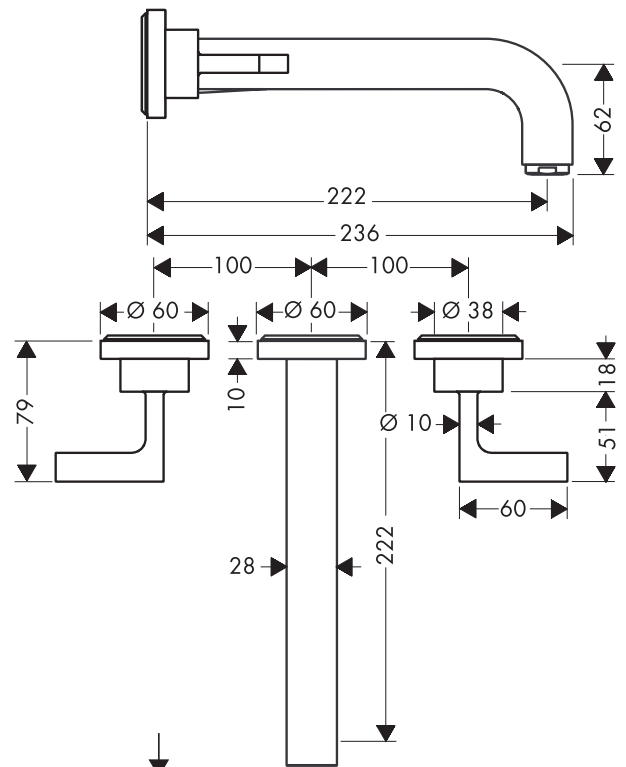
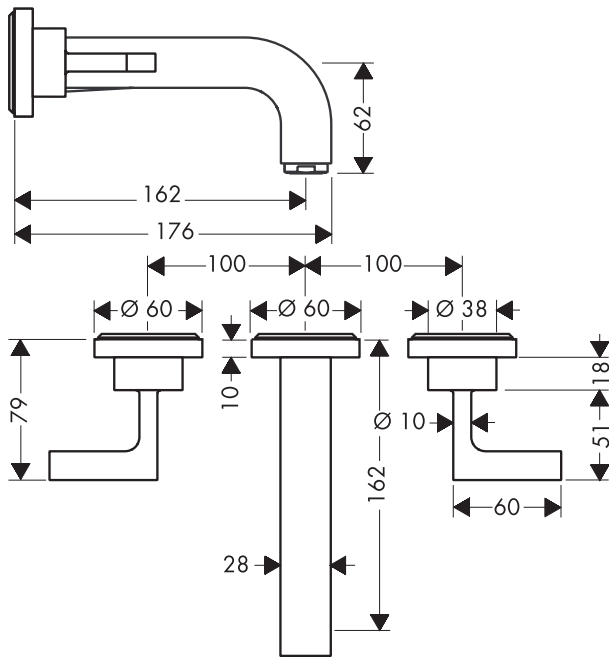
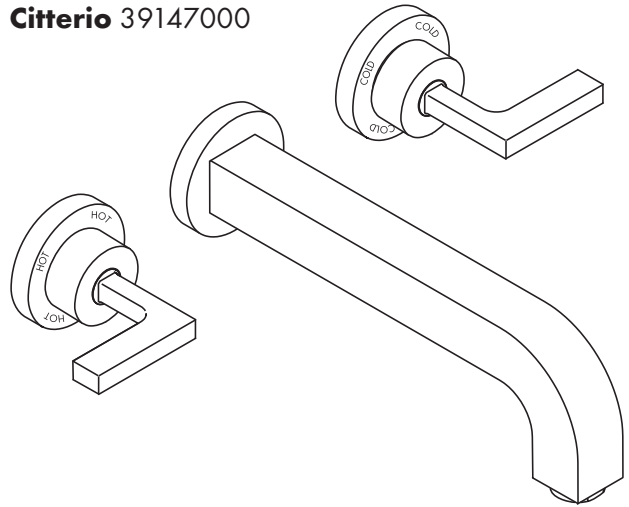



Citterio 39441000

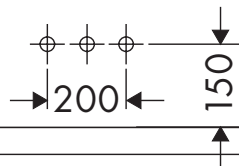
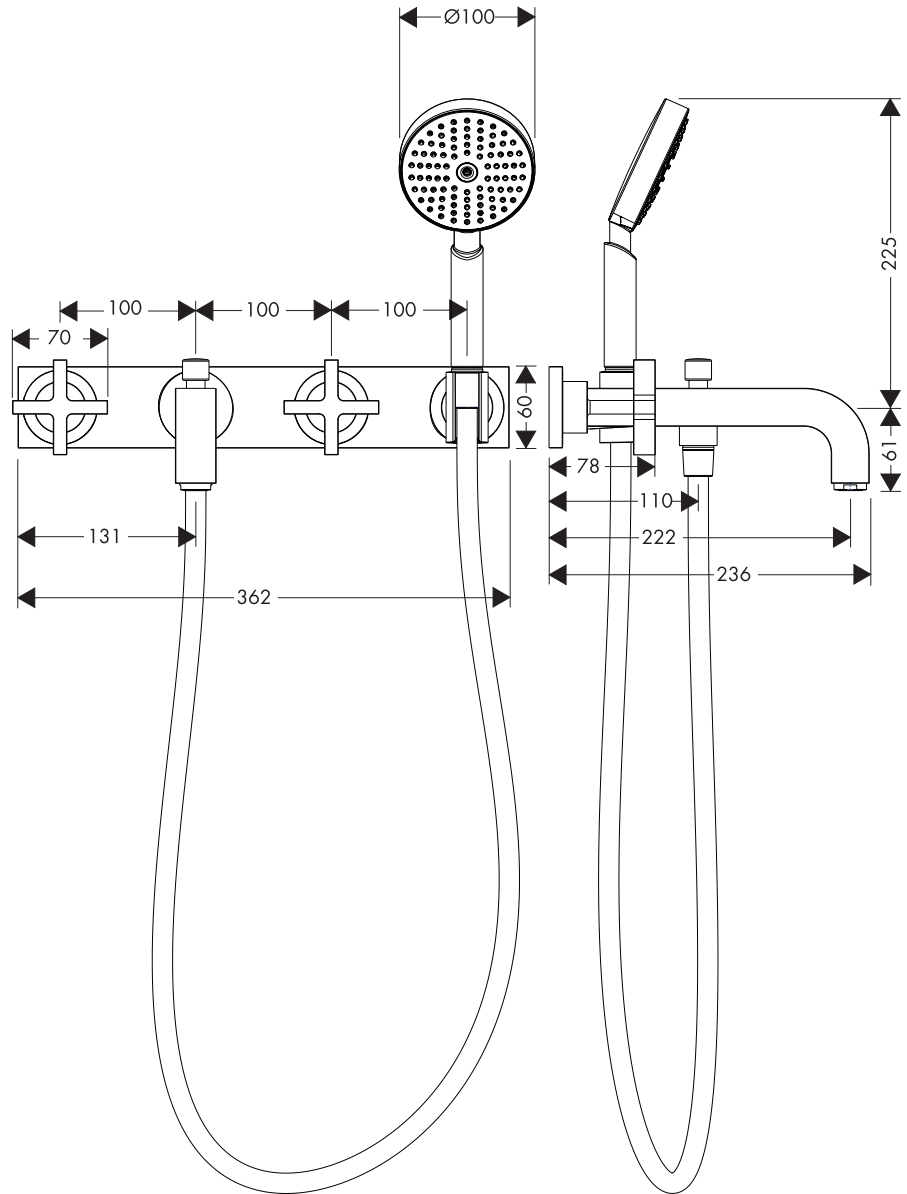
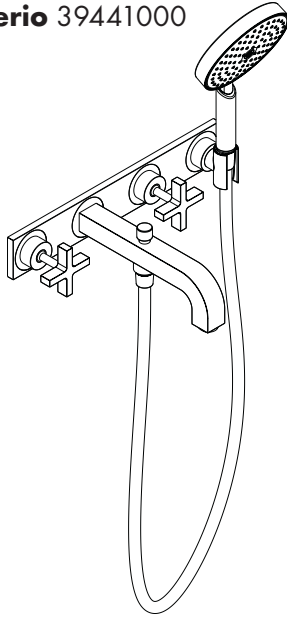



Citterio 39442000

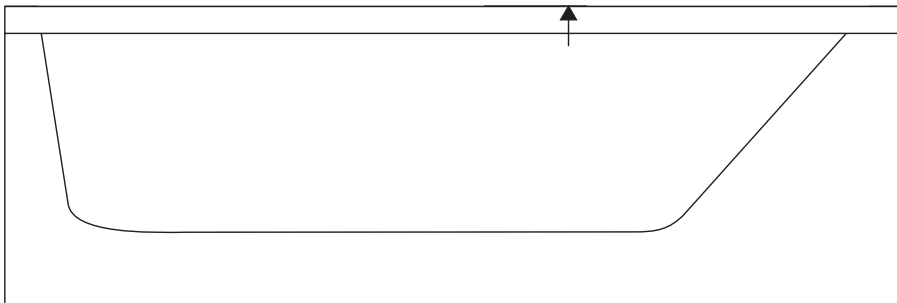
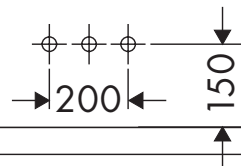
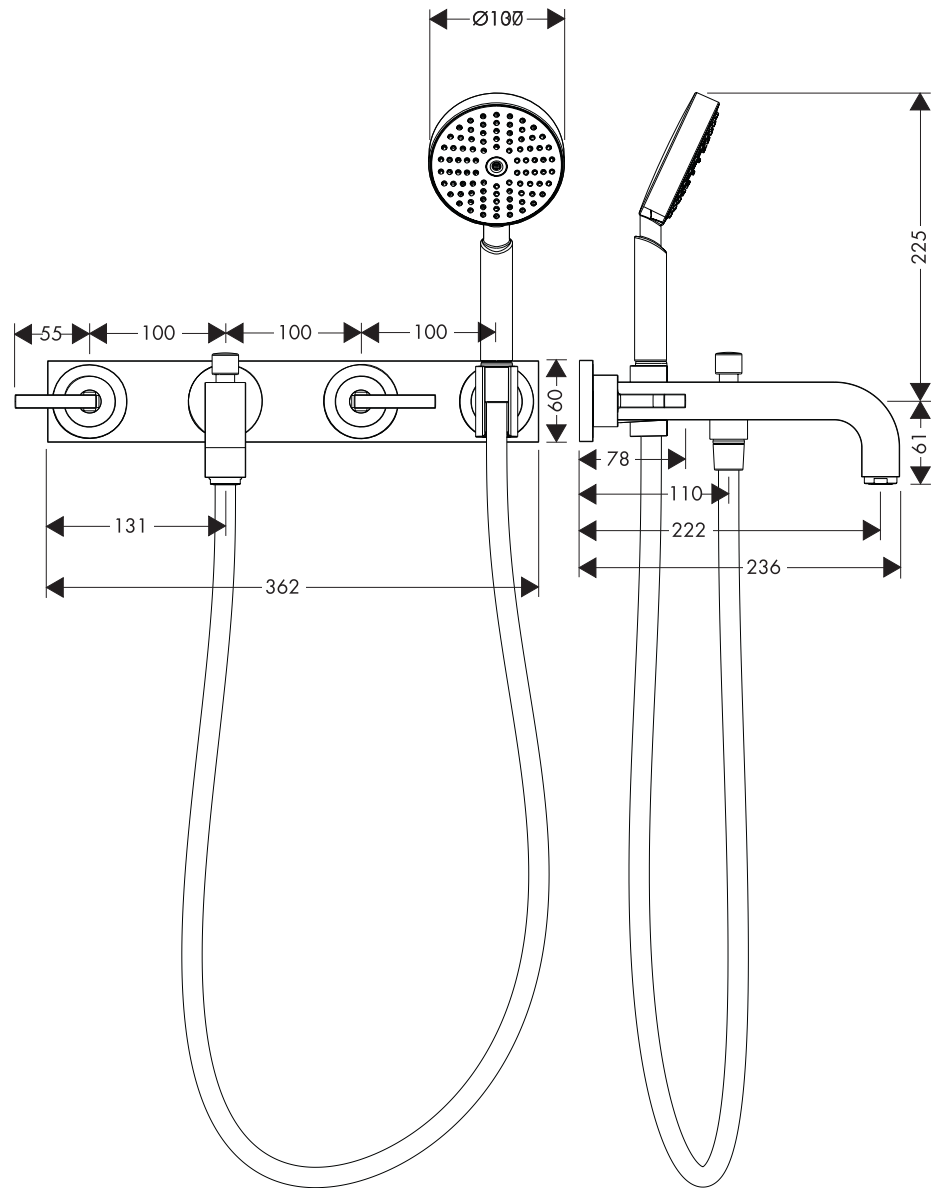
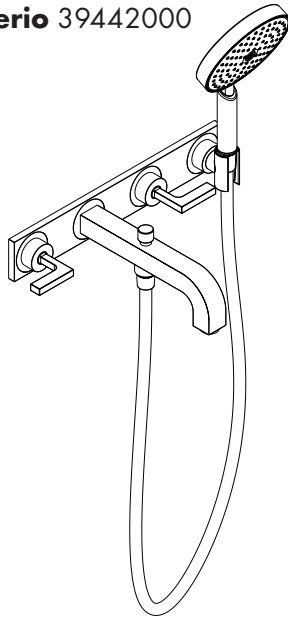



Citterio 39447000

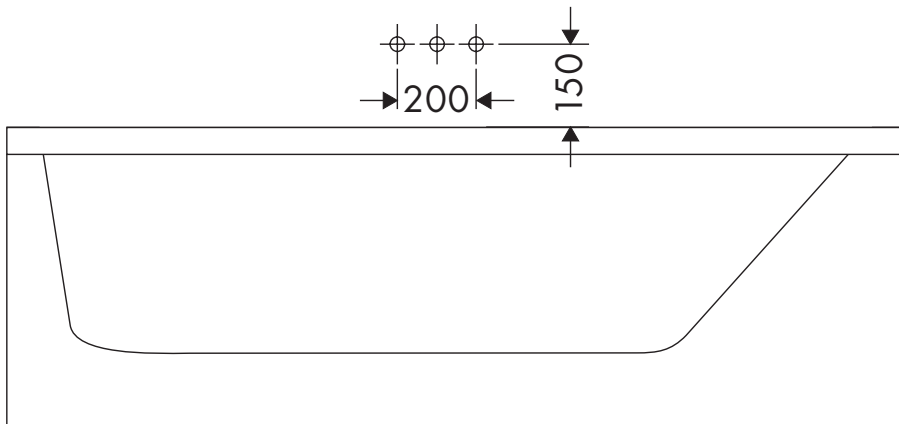
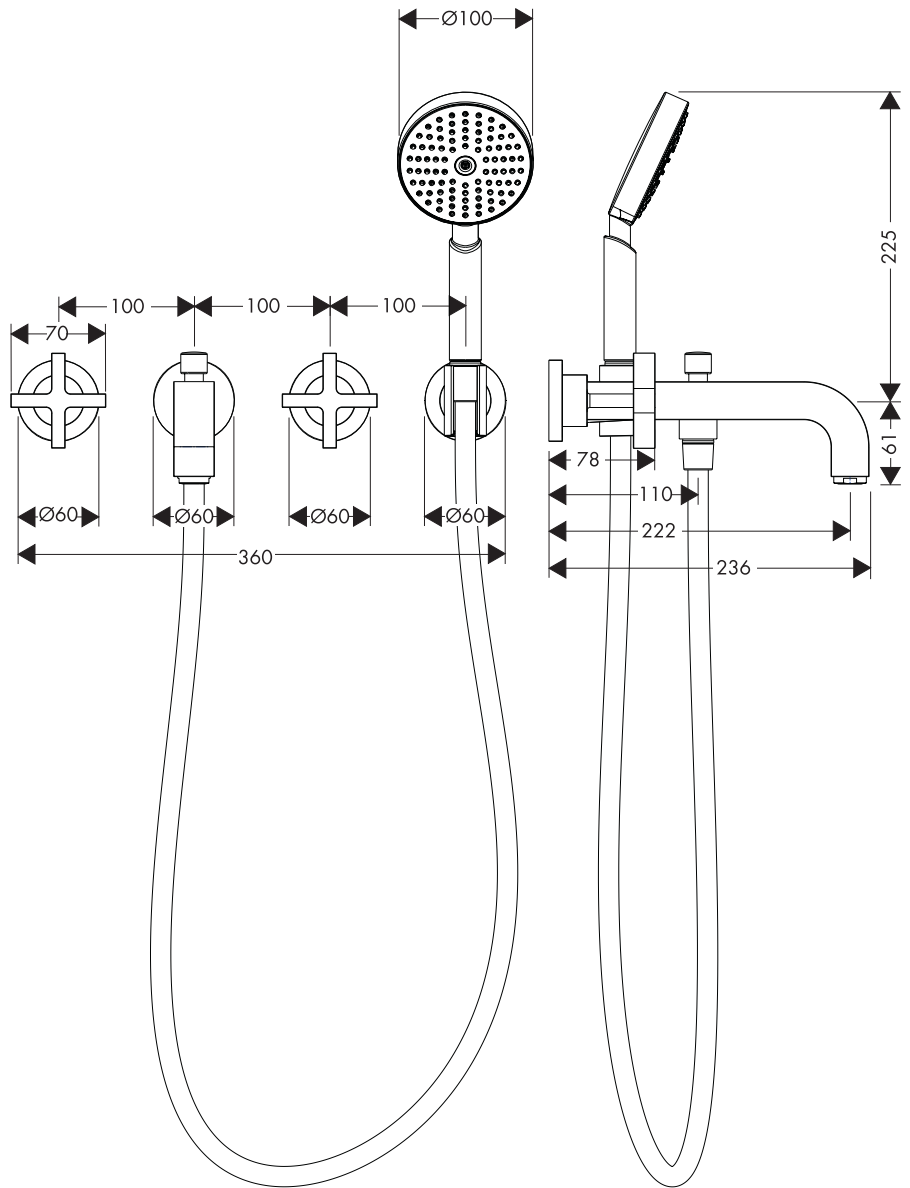
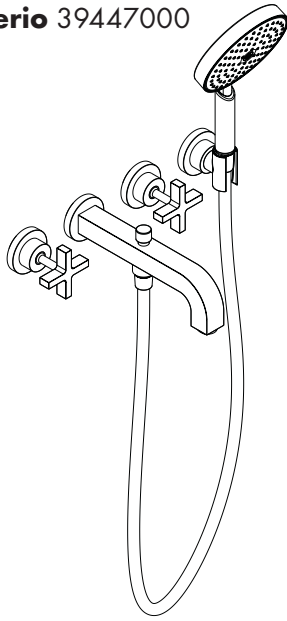





**Bouroullec 19135000**

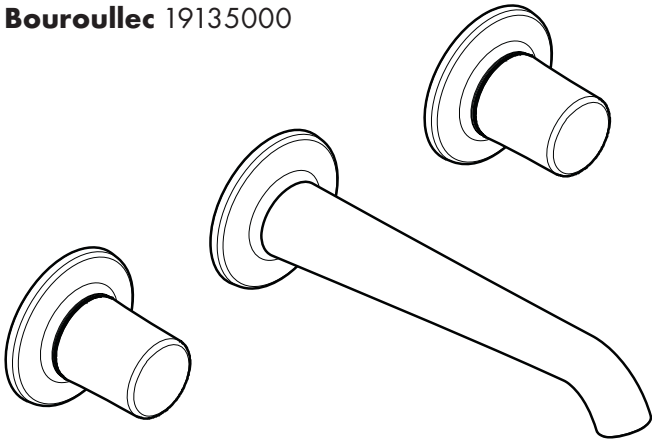

**Bouroullec 19136000**

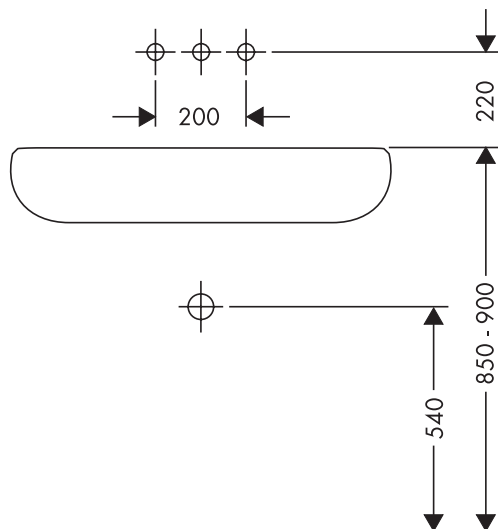
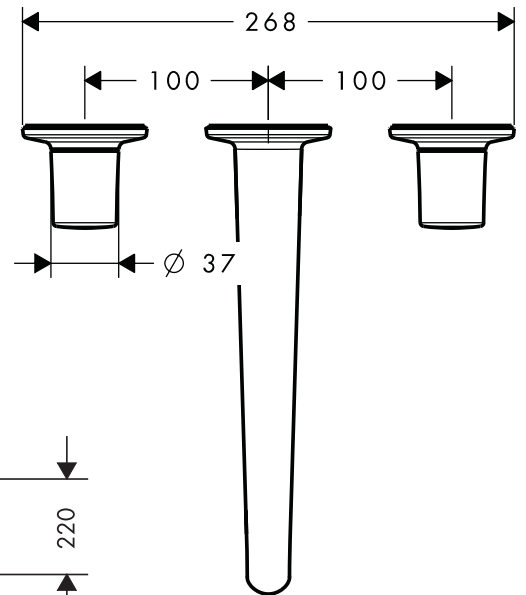
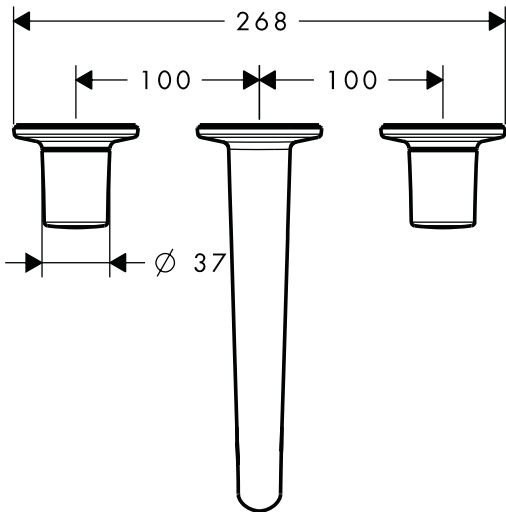
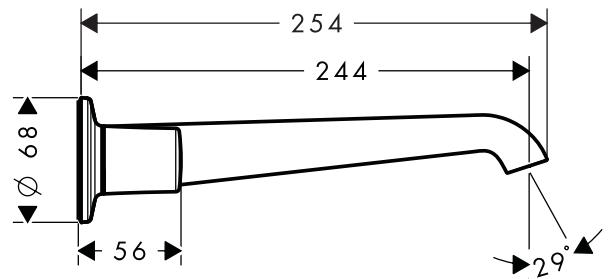
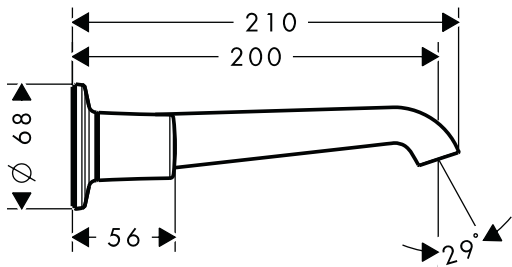
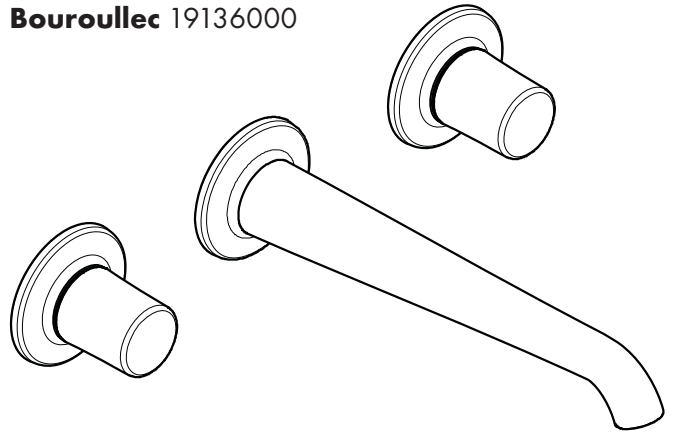

**Bouroullec 19158000**

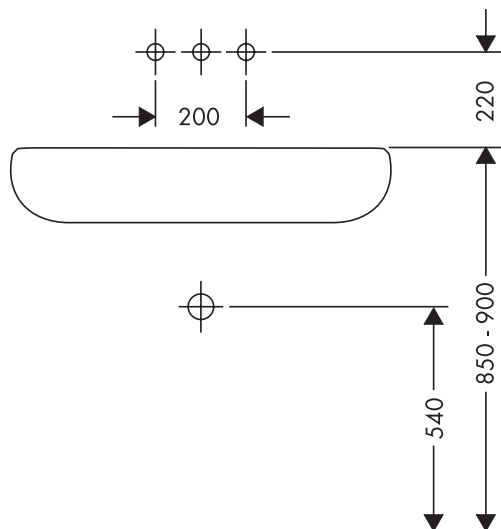
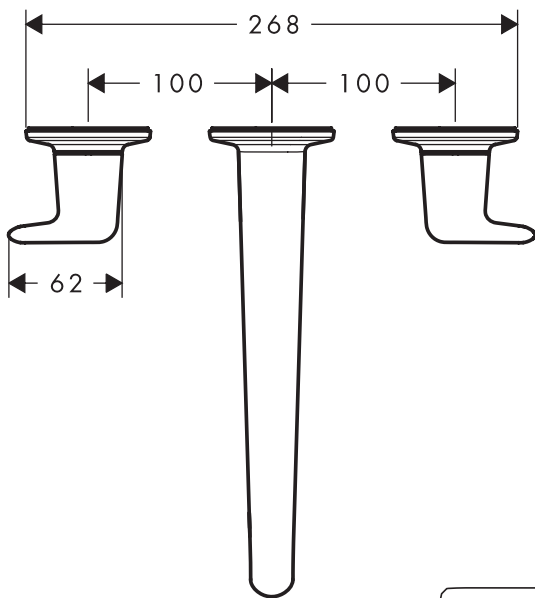
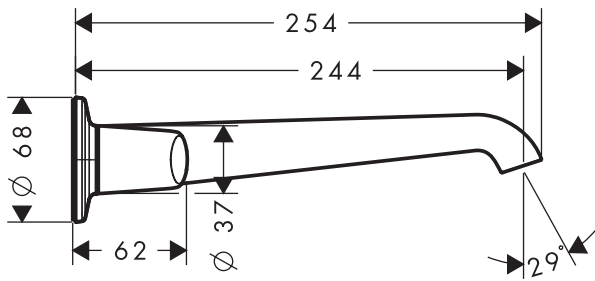
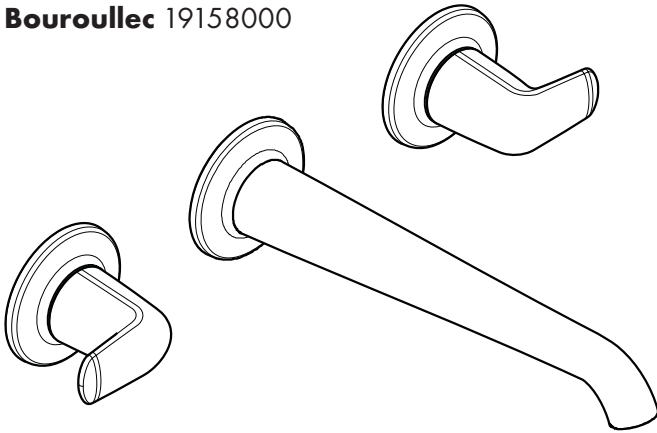







**P-IX**

**DVGW**

**SVGW**

**ACS**

**WRAS**

**ETA**



**GODKENDT  
TIL DRIKKEVAND**

**10303180**

P-IX 28536/IO

BT0602

X

X

X

 1.42/19070

X

