

Compact TAF



UK	INSTALLATION ADVICE
DE	Einbauempfehlung
NL	Inbouwadvies
DK	Montagevejledning
NO	Innbyggingsråd
ES	Consejo para la instalación
PT	Conselho de instalação
IT	Consigli di montaggio
FR	Conseils de montage
PL	Zalecenia dotyczące wbudowania

Easy Drain®

UK Contents
DE Inhalt
NL Inhoud
DK Indhold
NO Innhold

ES Contenido
PT Conteúdo
IT Contenuto
FR Table des matières
PL Zawartość

Installation options	3
Height adjustable support	4
Height adjustable support Wall	5
Installation guide	6
Sealing advice TAF (primary drainage)	9
Sealing advice TAF (secondary drainage)	10
Maintenance instructions	11
Siphon cleaning	12
Important assembling advice	13

Compact TAF

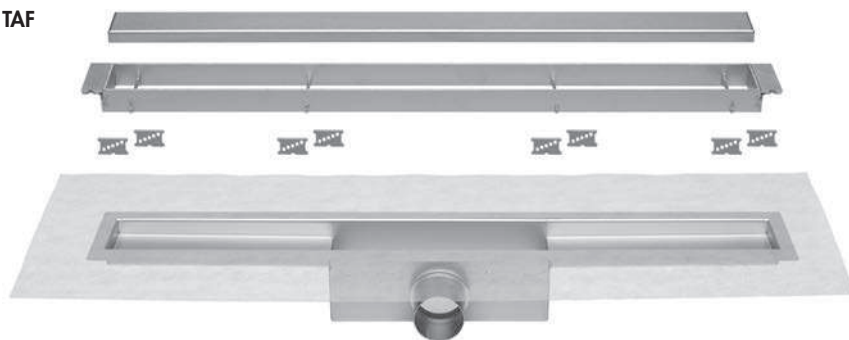

Compact TAF Wall

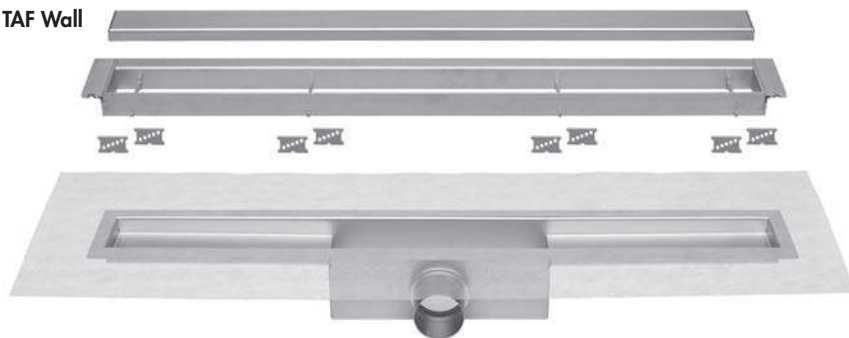

UK Installation options
DE Einbaumöglichkeiten
NL Inbouwvarianten
DK Installeringsvarianter
NO Innbyggingsvarianter

ES Opciones de instalación
PT Variantes de instalação
IT Varianti di montaggio
FR Variantes de montage
PL Warianty wmontowania

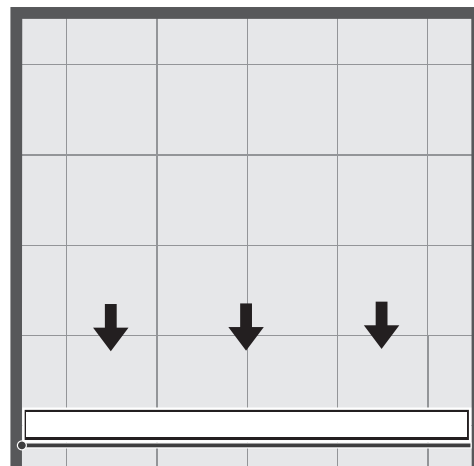
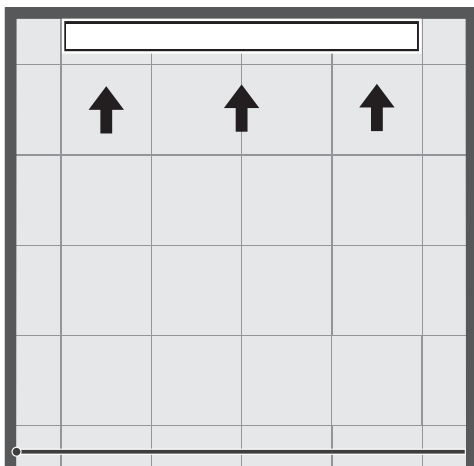
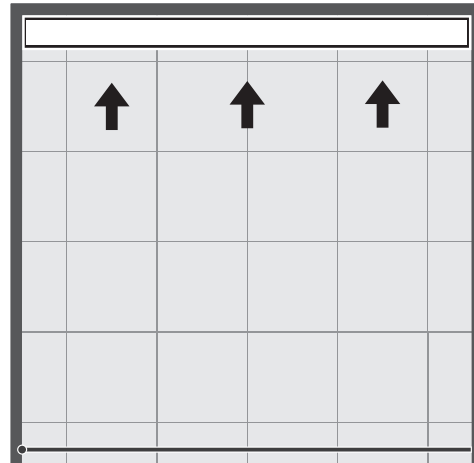
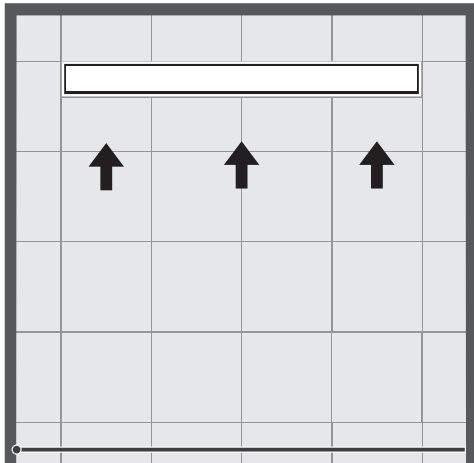

UK Height adjustable support

DE Stellfuß Montage

NL Stelvoet montage

DK Justering fod montering

NO Justeringsfot montering

ES Montaje del pie de ajuste

PT Montagem do pé nivelador

IT Montaggio del piede di regolazione

FR Socle de montage ajustable

PL Montaż na regulowanej stopce

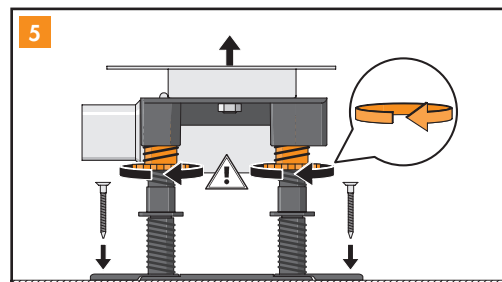
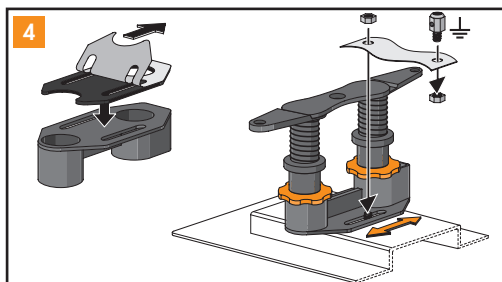
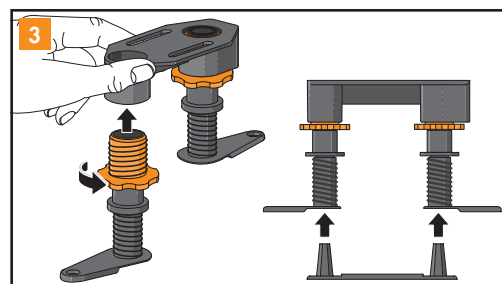
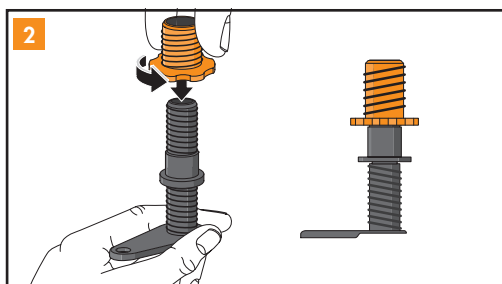
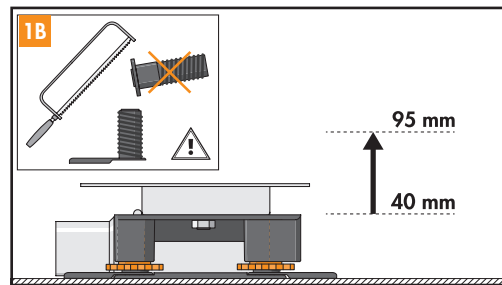
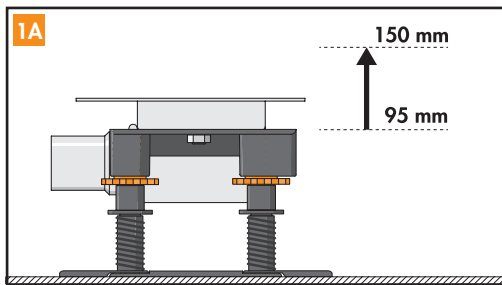

UK Height adjustable support | Wall

DE Stellfuß Montage | Wand

NL Stelvoet montage | Wand

DK Justering fod monterng | Væg

NO Justeringsfot monterng | Vegg

ES Montaje del pie de ajuste | Pared

PT Montagem do pé nivelador | Parede

IT Montaggio del piede di regolazione | Parete

FR Socle de montage ajustable | Mur

PL Montaż na regulowanej stopce | Ściana

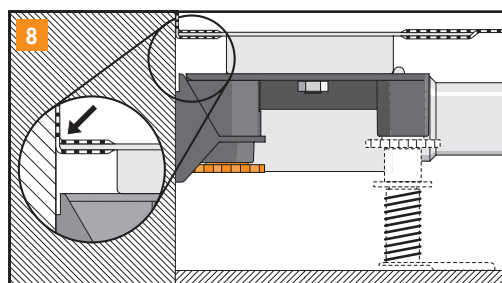
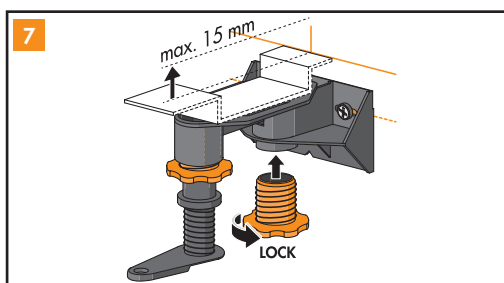
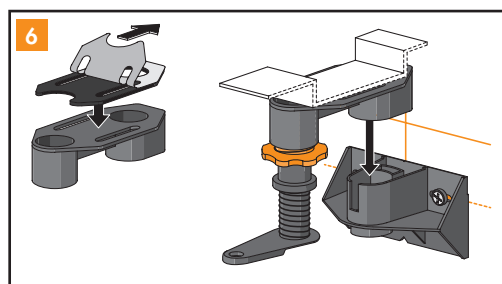
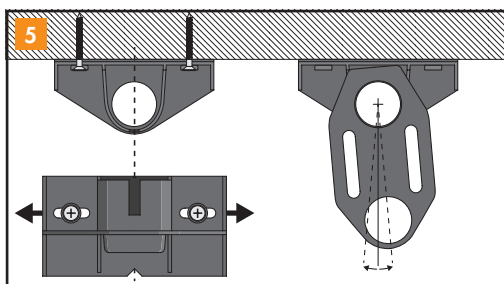
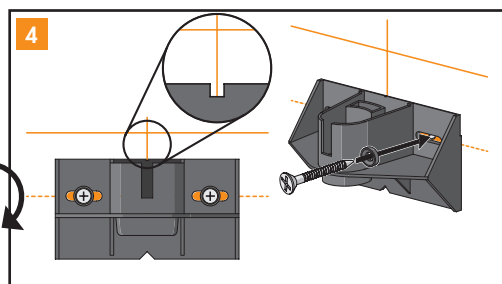
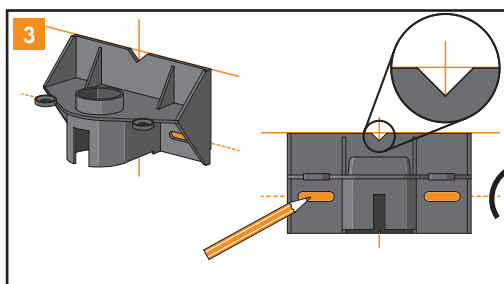
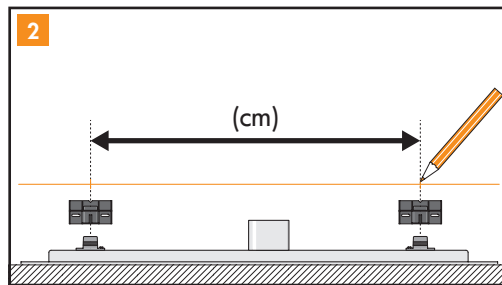
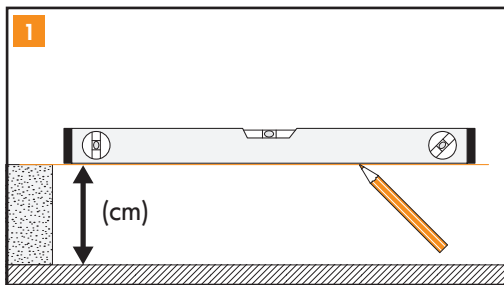

UK Installation guide
 DE Einbauempfehlung
 NL Inbouwhandleiding
 DK Montagevejledning
 NO Innbyggingsveiledning

ES Manual de instalación
 PT Instruções de instalação
 IT Istruzioni di montaggio
 FR Explications de montage
 PL Instrukcja wmontowania

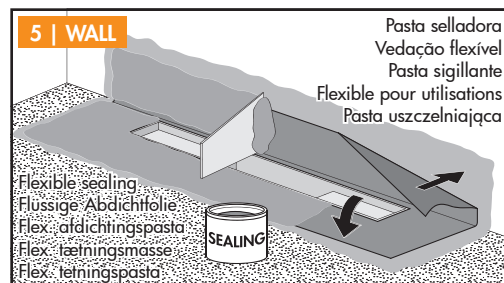
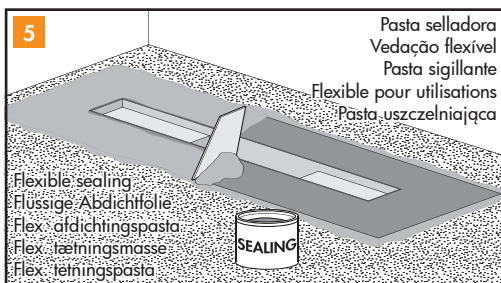
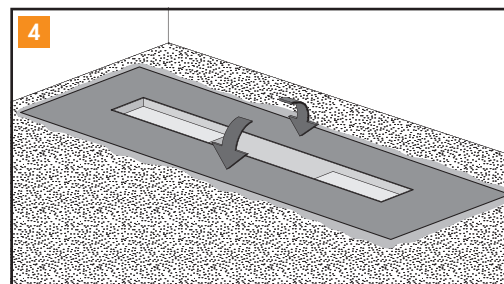
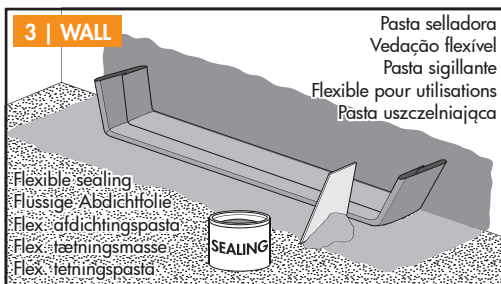
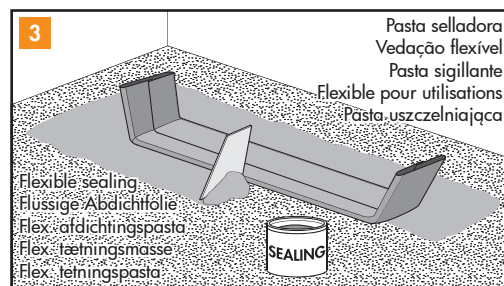
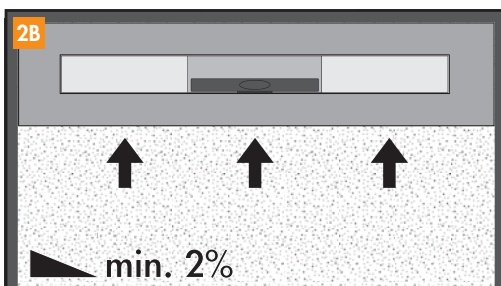
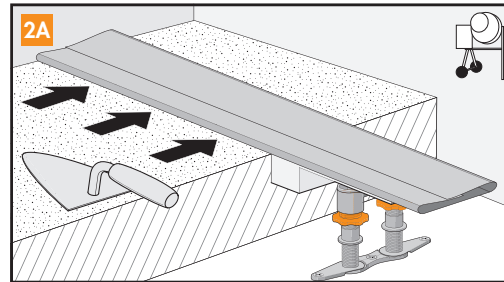
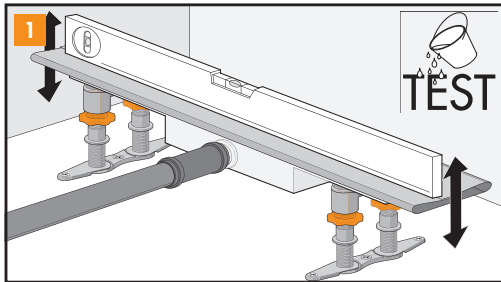

Easy Drain®

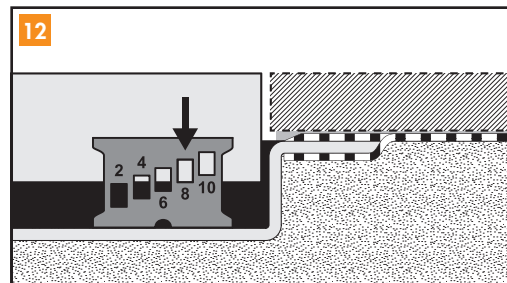
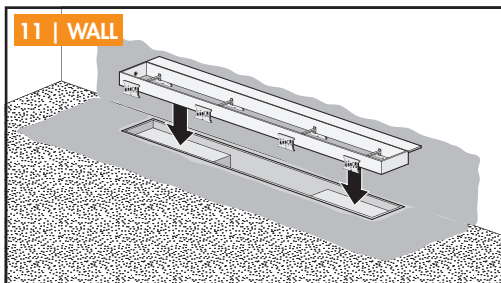
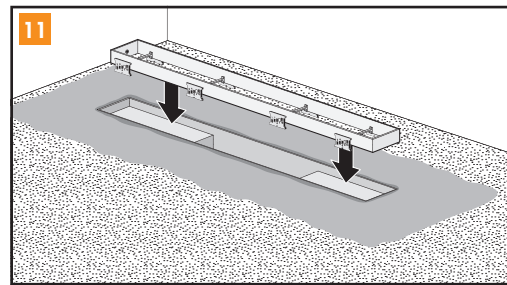
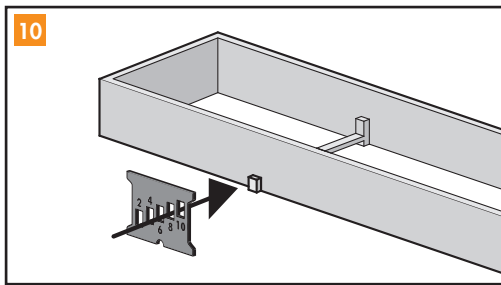
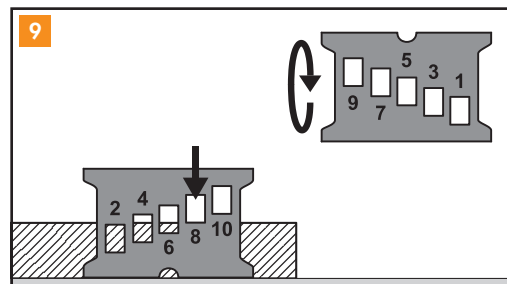
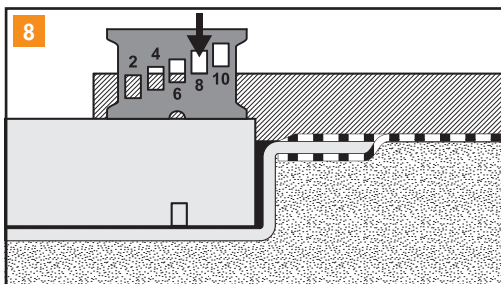
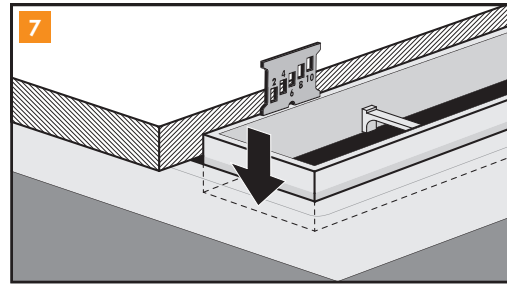
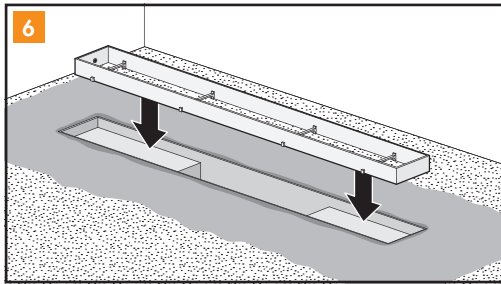

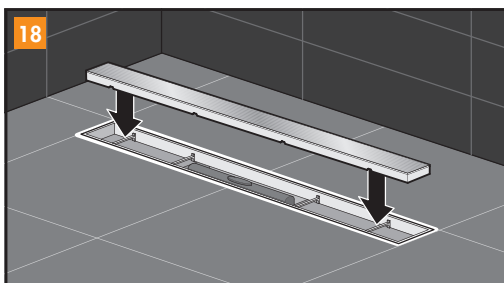
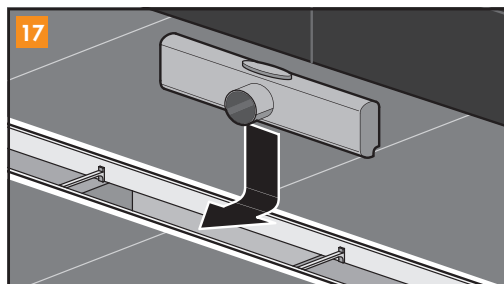
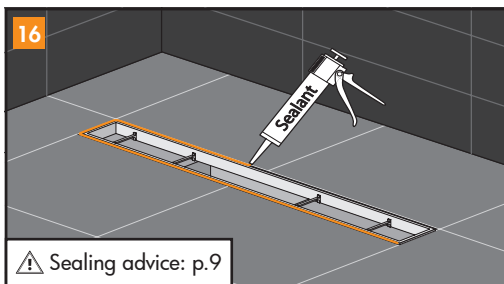
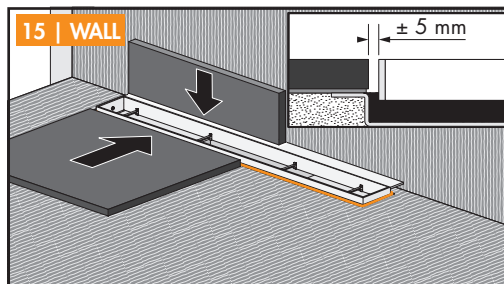
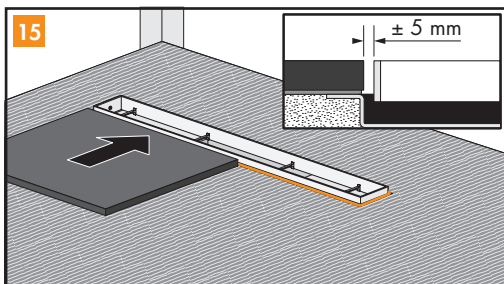
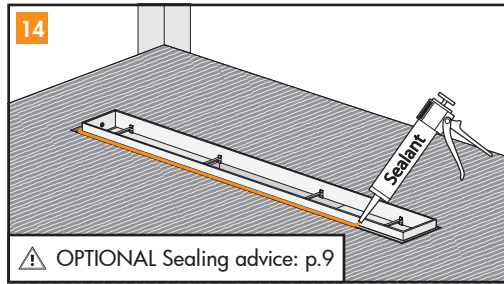
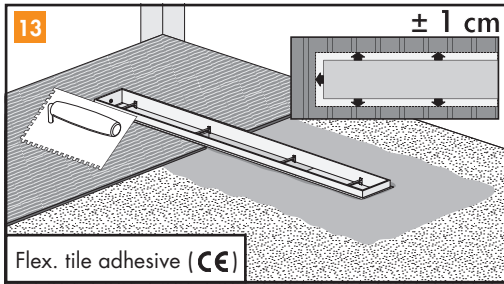
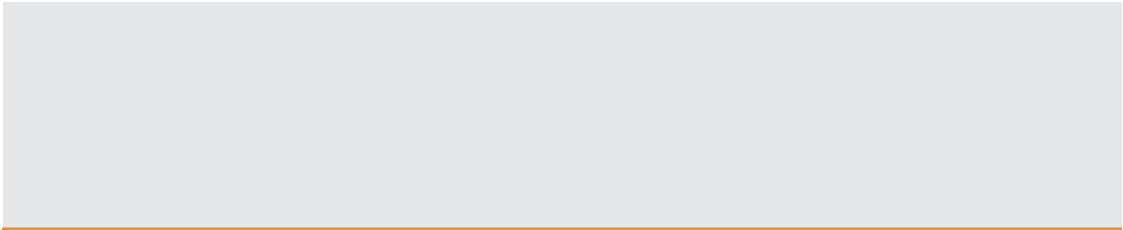

UK Sealing advice | TAF

DE Abdichtungsempfehlung | TAF

NL Afdichtingsadvies | TAF

DK Tætningsråd | TAF

NO Tetningsråd | TAF

ES Consejo de sellado | TAF

PT Conselho de vedação | TAF

IT Consigli per la sigillatura | TAF

FR Conseil pour étanchéifier | TAF

PL Zalecenia dotyczące uszczelniania | TAF



UK Only primary drainage

DE Nur Primärwasser Ableitung

NL Alleen primaire afwatering

DK Kun afledning af primærvand

NO Kun primær avløp

ES Sólo desagüe de agua primario

PT Só drenagem da água primária

IT Solo derivazione primario scarico

FR Seule évacuation primaire

PL Podstawowy systemu odpływowego

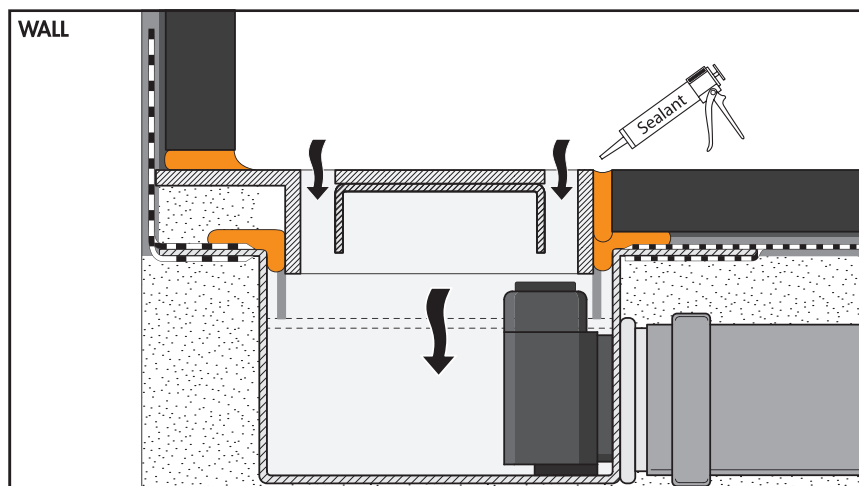
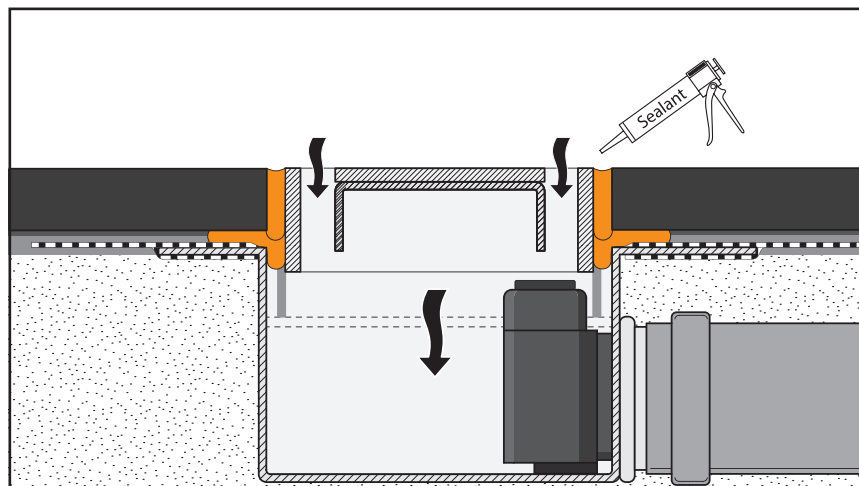

UK Sealing advice | TAF

DE Abdichtungsempfehlung | TAF

NL Afdichtingsadvies | TAF

DK Tætningsråd | TAF

NO Tetningsråd | TAF

ES Consejo de sellado | TAF

PT Conselho de vedação | TAF

IT Consigli per la sigillatura | TAF

FR Conseil pour étanchéifier | TAF

PL Zalecenia dotyczące uszczelniania | TAF



UK With secondary (undertile) drainage

DE Mit Sekundärwasser Ableitung

NL Met secundaire afwatering

DK Med afledning af sekundærvand

NO Med sekundær avløp

ES Con desagüe de agua secundario

PT Com drenagem da água secundária

IT Con derivazione secondo scarico

FR Avec évacuation secondaire

PL Z drugorzędneho systemu odpływowego

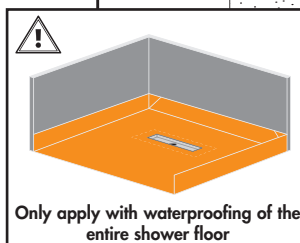
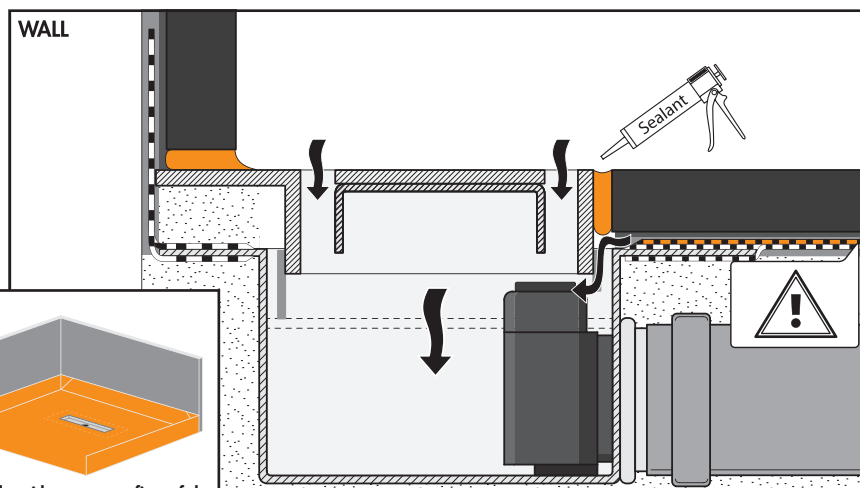
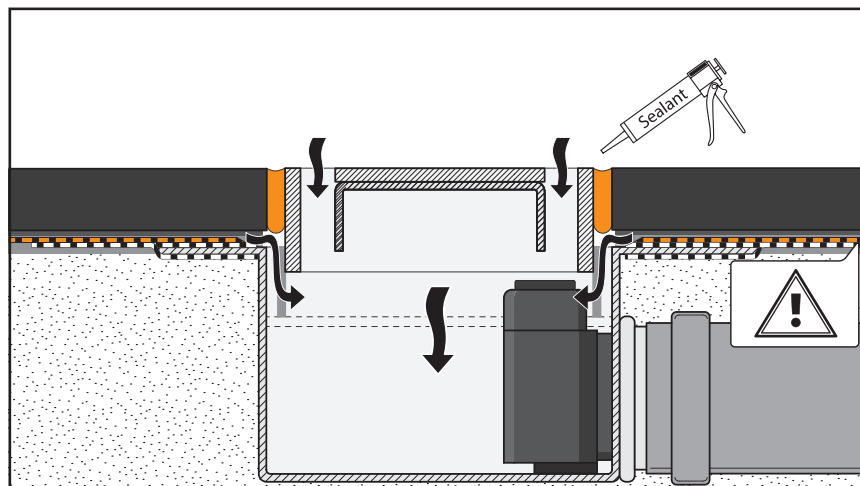

Only apply with waterproofing of the entire shower floor