

Parts list				Parts list			
ELEM.	CODE	DESCRIPTION	QT	ELEM.	CODE	DESCRIPTION	QT
1	ACPG13121	Plate 310x108x3 Int 115 PG	1	15.9	AQ0010946	Inox screw M6x12 DIN912	1
2	AQ0014224	Rubber packing double-sided tape 265x105x2	1	15.10	AQ0015510	Red plug G3/4"	1
3	AQ0013943	Rubber packing Ø60xØ45 H2	2	15.11	AQ0015511	Blue plug G3/4"	1
4	CP12900CC-1	Preassembled handle Ø45 knurled	2	15.12	AQ0015779	Ceramic diverter 2 ways (BF#15109)	1
4.1	AC0012900	Handle Ø45 H20 knurled	1	15.13	AS0012443	Cartridge fixing nut M37x1.5 H11.2	1
4.2	AQ0001082	Grubscrew M4x4 cone point	2	15.14	AS0012444	Brass tube M24x1 H26	1
5	AQ0002160	Screw M4x10	1	15.15	AQ0013322	Inox M4x6	1
6	CP7043CCPG-1	Thermo regulation handle body	1	15.16	AQ0013461	Protecting cap thread Ø19	2
6.1	AC0007043	Handle thermo regulation	1	15.17	AQ0004630	OR 17.16x1.78 NBR 70 SH	1
6.2	AQ0008086	Spring for thermo plug Ø6 F0.5 L8.5	1	15.18	AQ0006680	Plug G1/2" M	1
6.3	AC0011424	Plug for thermo handle H27	1				
6.4	AS0007045	Pin for thermo lever button Ø6 H11.6	1				
7	AS0013025	Centering bush Ø40.95 Ø41.95 H25	1				
8	AC0011535	Support Ø45 H25.5 M36x1.5	1				
9	AQ0009809	Inox screw M4x30	1				
10	AC0007042	Capacity handle body	1				
11	AS0013024	Centering bush Ø40.95 Ø40.35 H18.5	1				
12	AS0013023	Ring Ø45 H23.6 M42x1.5	1				
13	AS0013022	Reduction M24x1 M42x1.5 H6	1				
14	AS0009598	Extension 6x20 H34.8	1				
15	CP1AD20C-C-1	Preassembled the mostall with 2 ways diverter	1				
15.1	AQ0009148	Screw M4x20 ISO 7045	1				
15.2	AQ0013518	Protection carrier Ø47 H52	2				
15.3	AQ0013541	Label MIN MAX	1				
15.4	AQ0010474	Temperature regulation stop	1				
15.5	AQ0011042	Thermo cartridge CA43 XF-01	1				
15.6	CT0002396	Thermostatic valve with diverter G1/2" G3/4"	1				
15.7	CP12312-19	Preassembled not return valve hot	1				
15.7.1	AQ0009818	OR 14x1.78 NBR 70 SH	3				
15.7.2	AQ0008089	OR 20.29x2.62 NBR 70 SH	1				
15.7.3	AS0012312	Not return valve body Hot 24x19 H53	1				
15.7.4	AQ0014461	Diskette Ø15 netrowk micro P.3	1				
15.7.5	AQ0015798	Not return valve Ø15 OF15 (31.0006.0)	1				
15.7.6	AS0012578	Stop valve Ø14.5 Ø12 H26	1				
15.7.7	AQ0004620	OR 4.47x1.78 NBR 70 SH	1				
15.7.8	AS0012776	Valve stop Ø7.5 H39.4 M6 M5	1				
15.7.9	AS0012415	Plug for valve M17x1 H15.5 with cross	1				
15.7.10	AS0012777	Nut M5 H4 Ø7.5	1				
15.8	CP12311-19	Preassembled not return valve cold	1				
15.8.1	AQ0009818	OR 14x1.78 NBR 70 SH	3				
15.8.2	AQ0008089	OR 20.29x2.62 NBR 70 SH	1				
15.8.3	AS0012311	Not return valve body cold 24x19 H53	1				
15.8.4	AQ0014461	Diskette Ø15 netrowk micro P.3	1				
15.8.5	AQ0015798	Not return valve Ø15 OF15 (31.0006.0)	1				
15.8.6	AS0012578	Stop valve Ø14.5 Ø12 H26	1				
15.8.7	AQ0004620	OR 4.47x1.78 NBR 70 SH	1				
15.8.8	AS0012776	Valve stop Ø7.5 H39.4 M6 M5	1				
15.8.9	AS0012313	Plug for valve M17x1 H15.5	1				
15.8.10	AS0012777	Nut M5 H4 Ø7.5	1				

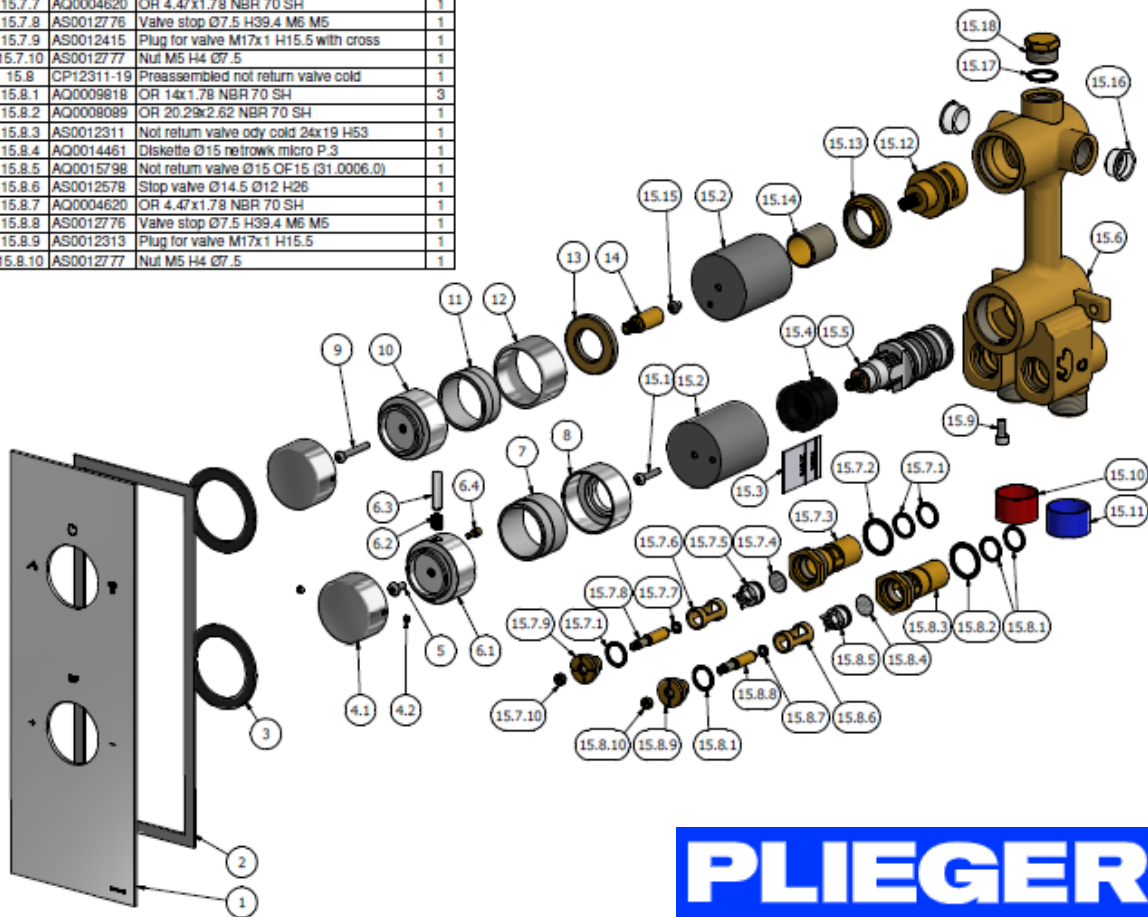

PLIEGER