

parte estetica
aesthetics

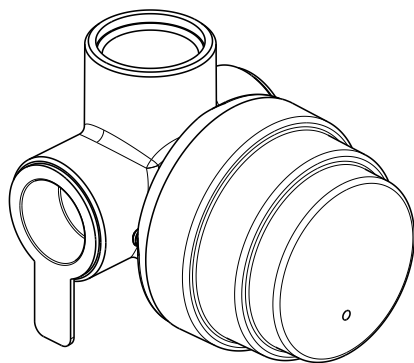
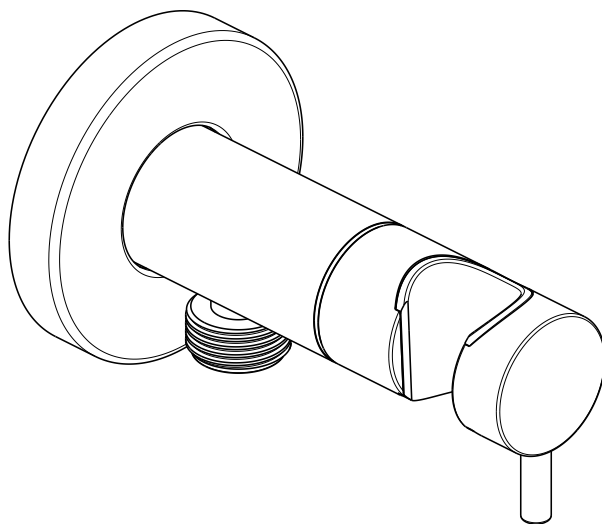

parte incasso
built-in component

WC Mixer

1

CONTENUTO DELLA CONFEZIONE PACKAGE CONTENT

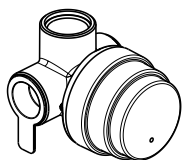

X1



X2

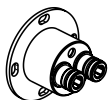

X1



X4

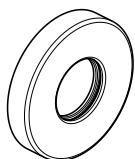

X1

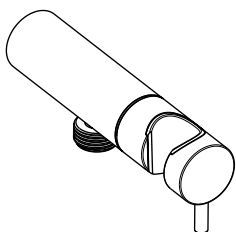

X1

- | IT | Istruzioni di montaggio
- | GB | Mounting instructions
- | FR | Instructions de montage
- | DE | Montageanweisungen
- | ES | Instrucciones de montaje



Campo di pressione min/max 0,5/5 bar (in caso di pressione dell'acqua superiore ai 5 bar si consiglia l'installazione di riduttori di pressione. Pressione consigliata da 1 a 3 bar.

Funzionamento:

Sia con scaldabagni a gas che elettrici ad accumulo.

Impianti centralizzati

Caldie murali.

Attenzione: consultare il proprio idraulico di fiducia per la scelta del dispositivo di riscaldamento più idoneo.

Pressure range min/max 0,5/5 bar (in case of water pressure higher than 5 bar we recommend installing pressure reducers).

Recommended pressure from 1 to 3 bar.

Operation:

Either with gas or electric accumulation boilers.

Centralised systems.

Warning: contact the plumber for the choice of the best water heating device.

diagramma di portata / flowrate



tabella di portata (litri/min)

	Pressione Dinamica (bar) / Portata (Litri/min)									
Bar	0.5	1	1.5	2	2.5	3	3.5	4	4.5	5
Portata/litri/min	3.63	5.17	6.38	7.38	8.21	8.93	9.57	10.13	10.67	11.14

parte estetica
aestheticsparte a incasso
built-in component

indicazioni di incasso:
built-in indications:

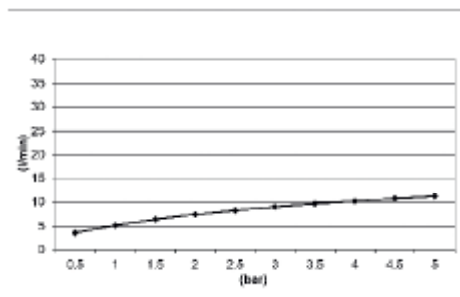
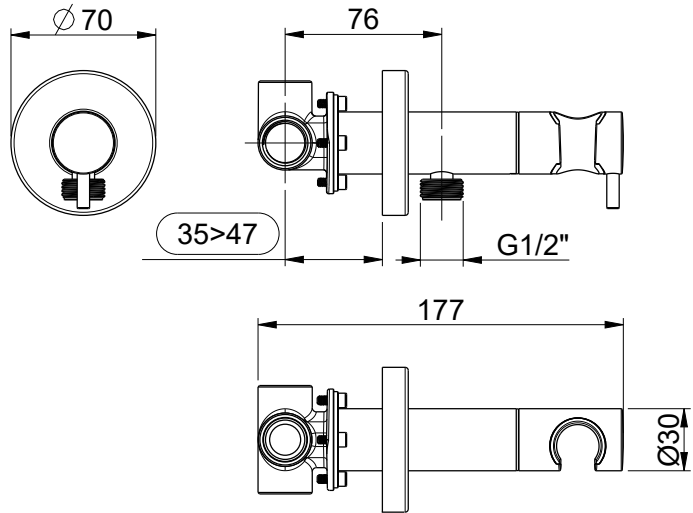
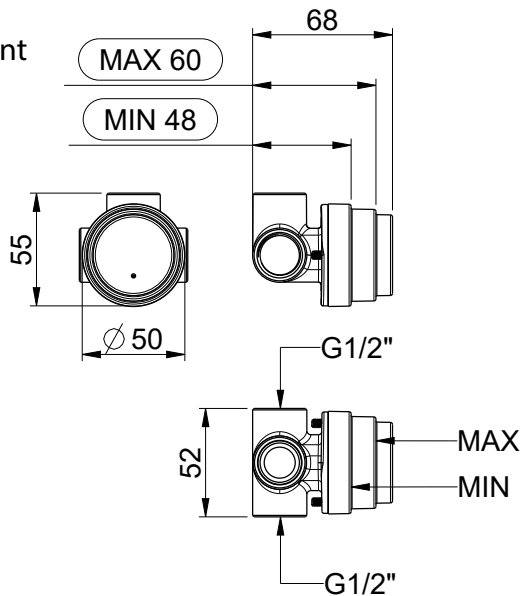
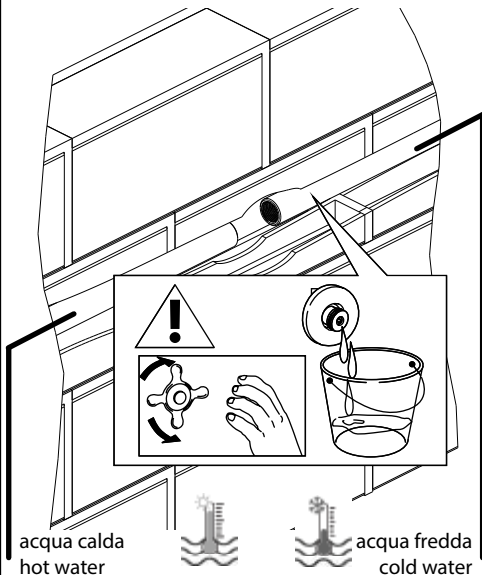
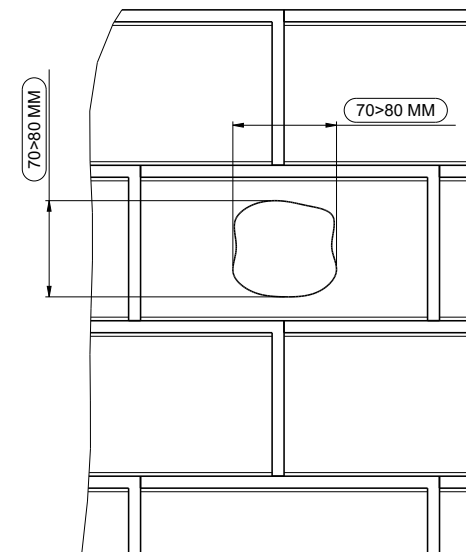

rimuovere protezioni filetti
remove protections

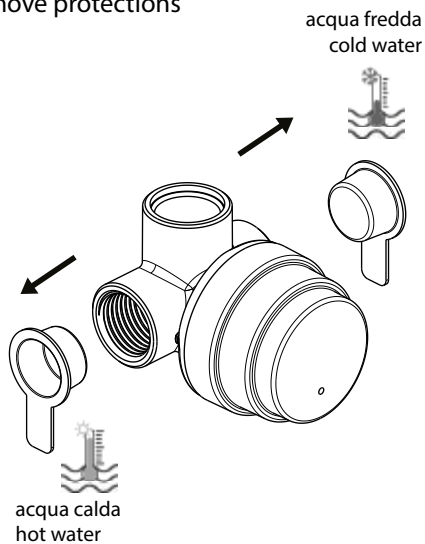

sigillare con teflon
seal off with teflon

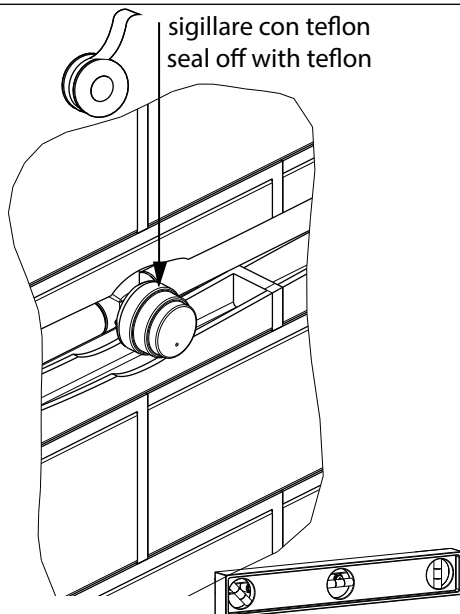

verificare allineamento | check the alignment

indicazioni di incasso: MIN/MAX | built-in indications: MIN/MAX

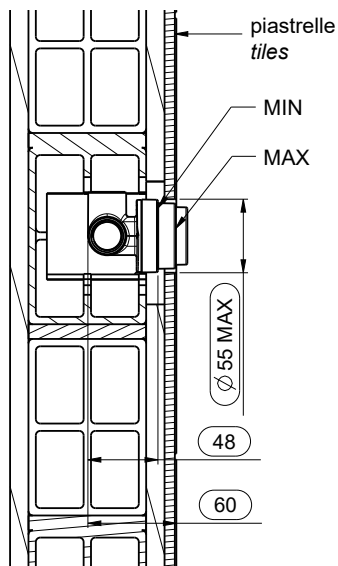

in fase di piastrellatura porre attenzione ai riferimenti di minimo e massimo
during tiling pay attention to the minimum and maximum indications

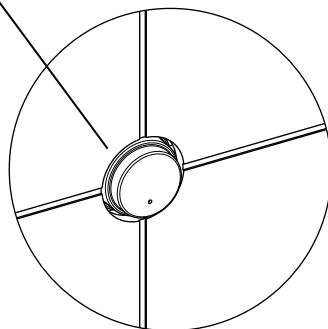

collaudo impianto e rimozione guscio protettivo | plant testing and removal of the protective shell

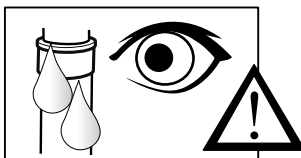
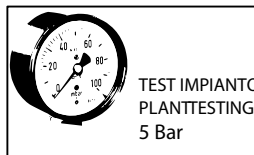
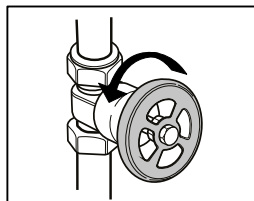
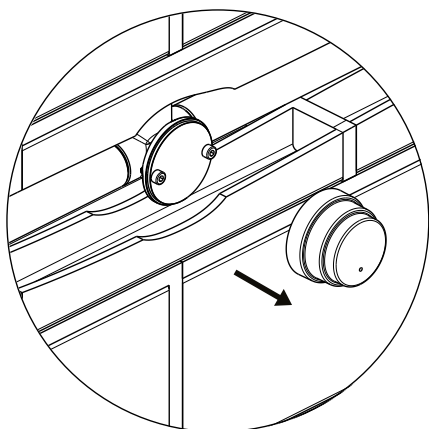

rimozione piastra per collaudo | remove plate-testing

3

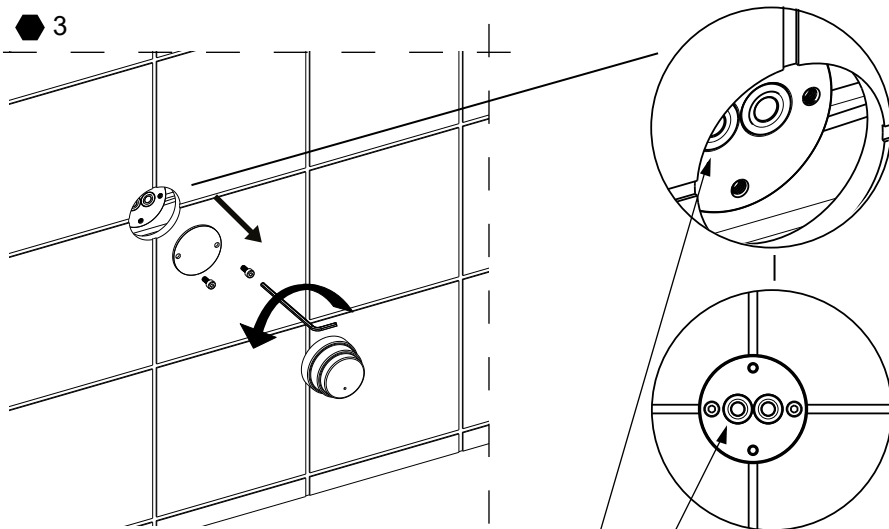

N.B. dopo avere rimosso la piastra porre attenzione al corretto posizionamento degli oring di tenuta
after removing the plate, pay attention to the correct positioning of the o-rings

montaggio corpo estetico | aesthetic mounting

attenzione a non danneggiare gli oring
pay attention to not damage the o-rings

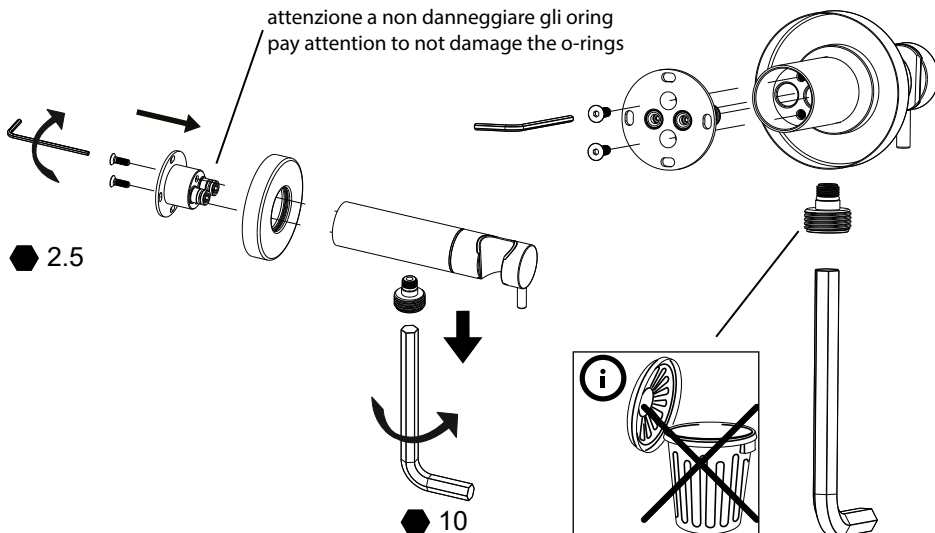

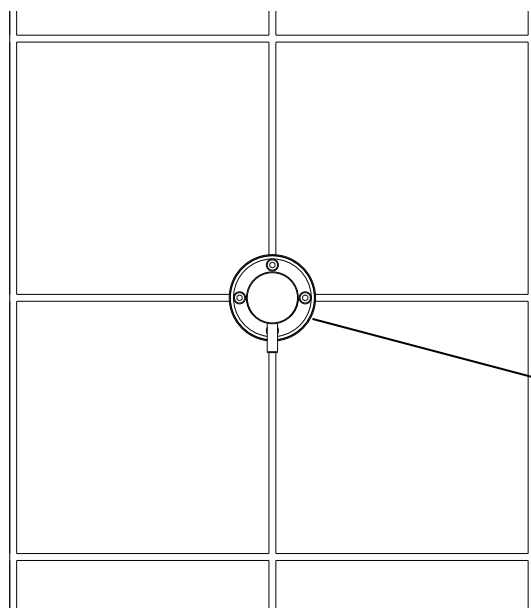
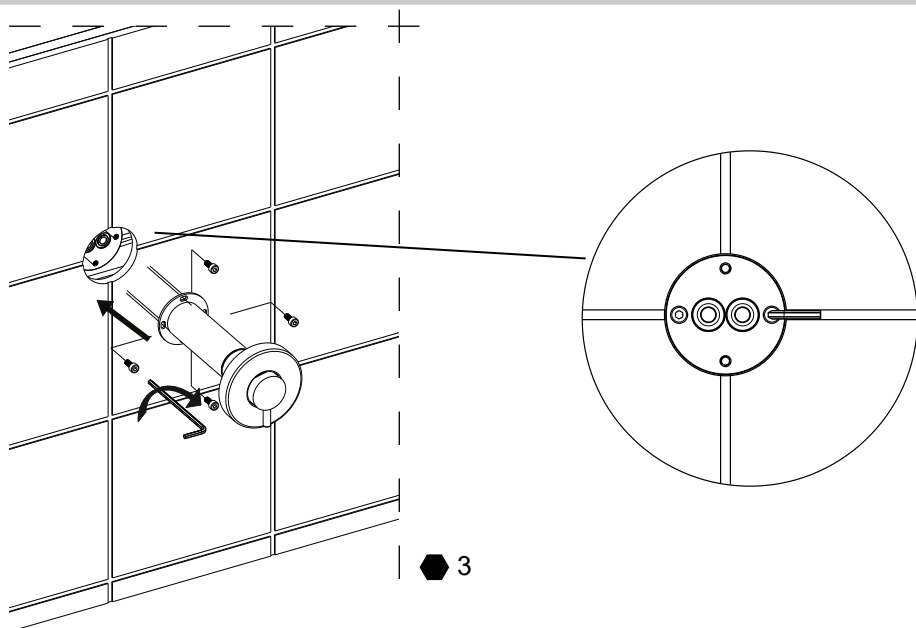

aggiustare l'allineamento del corpo
prima di stringere le viti
before tighten the screws pay attention
to the aesthetic body alignment

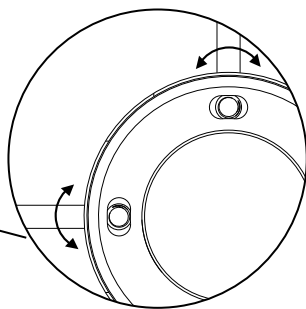

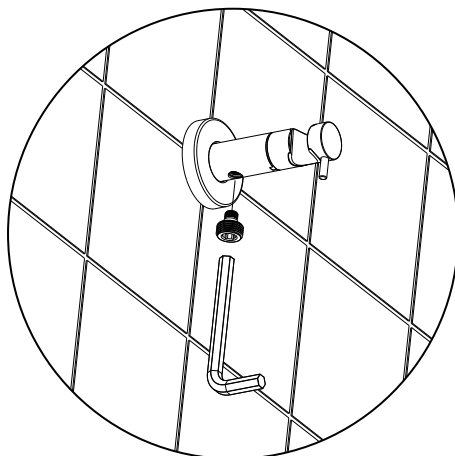
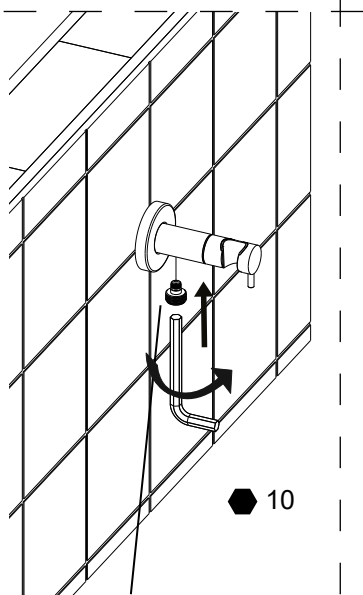
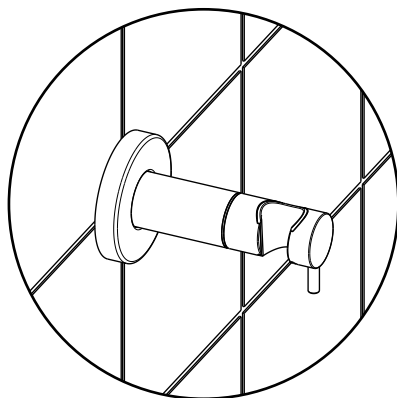
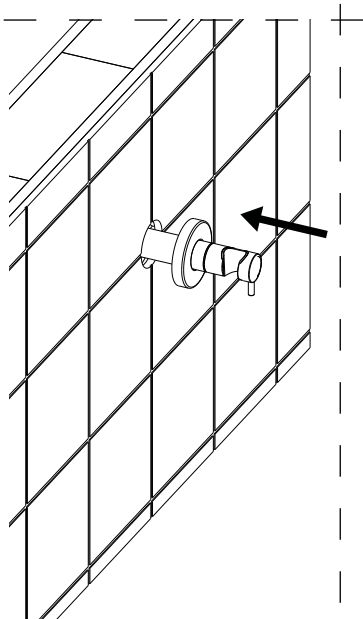

attenzione a non danneggiare gli oring | pay attention to not damage the o-rings

sostituzione boccola | joint replacement

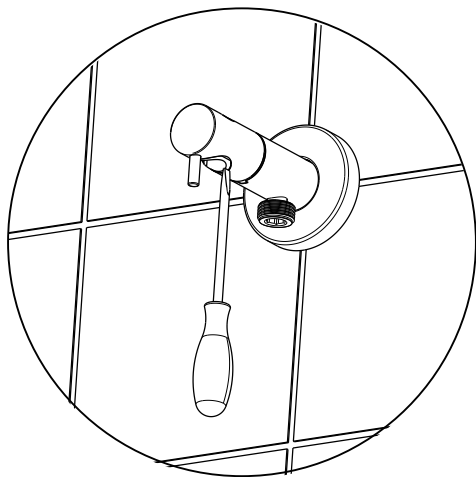

attenzione a non danneggiare il
corpo estetico | pay attention to
not damage the aesthetic body

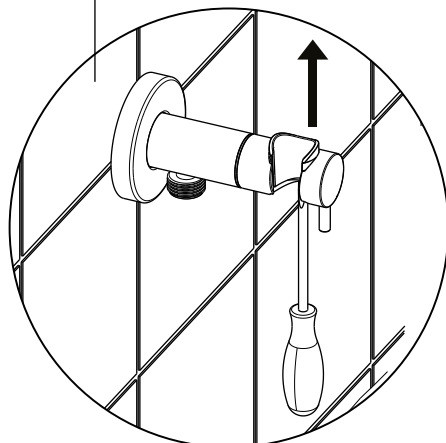

fare leva utilizzando il cacciavite per sganciare la boccola dalla sede | use the screwdriver to remove the

inserimento nuova boccola | new joint insertion

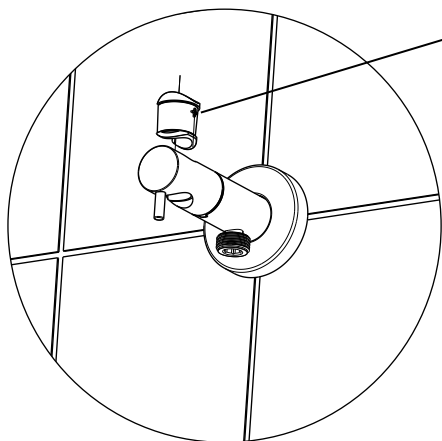

allineare il riferimento con la sede |
align the new joint with reference seat

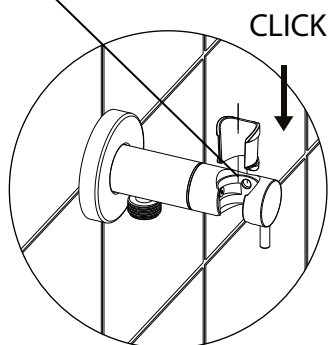

sostituzione cartuccia | cartridge replacement
N.B. estrarre la boccola | remove the joint

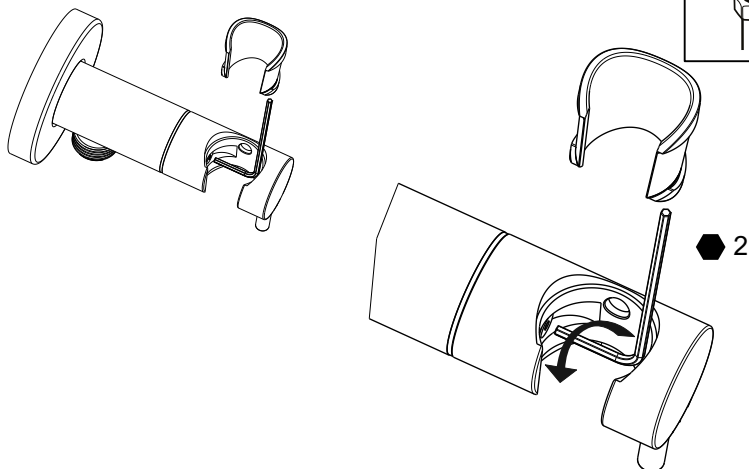
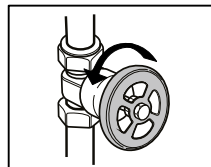

PRIMA DI SOSTITUIRE LA CARTUCCIA CHIUDERE L'IMPIANTO IDRICO
BEFORE REPLACE CARTRIDGE, CLOSE THE WATER SYSTEM

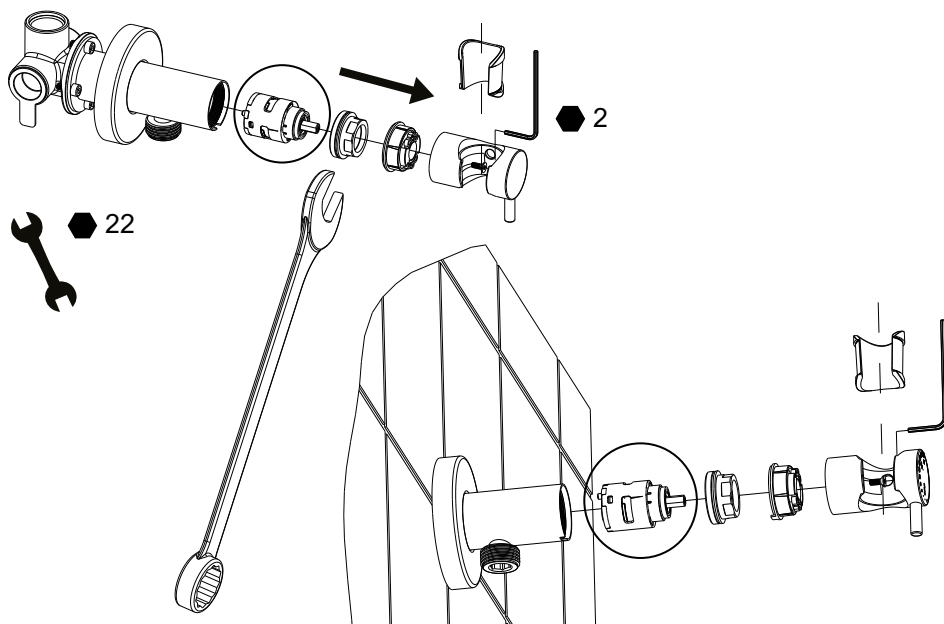

N.B. nell'inserire la nuova cartuccia accertarsi che i perni siano rivolti verso l'alto e si inseriscano nell'apposita sede | inserting the new cartridge make sure that the pins are facing upwards and insert them in the appropriate position

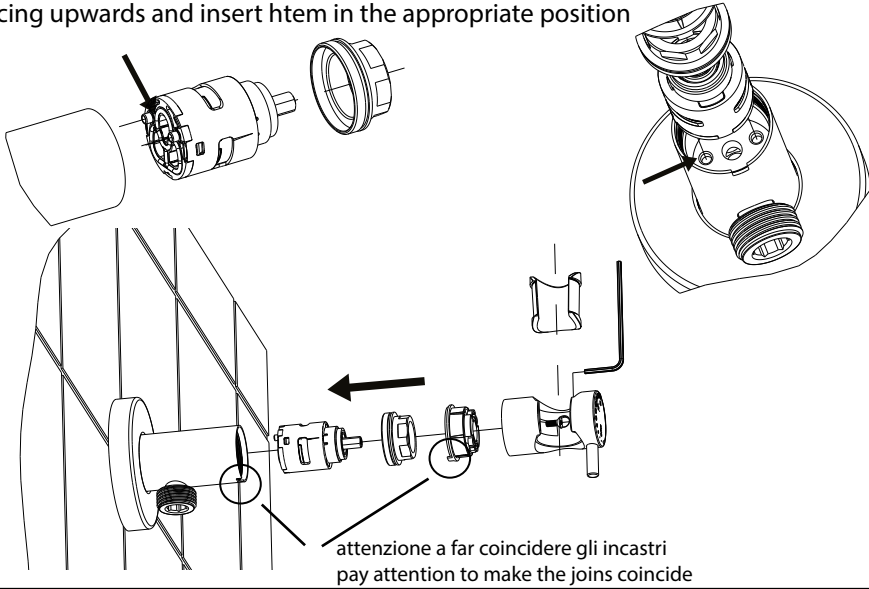

FUNZIONAMENTO OFF

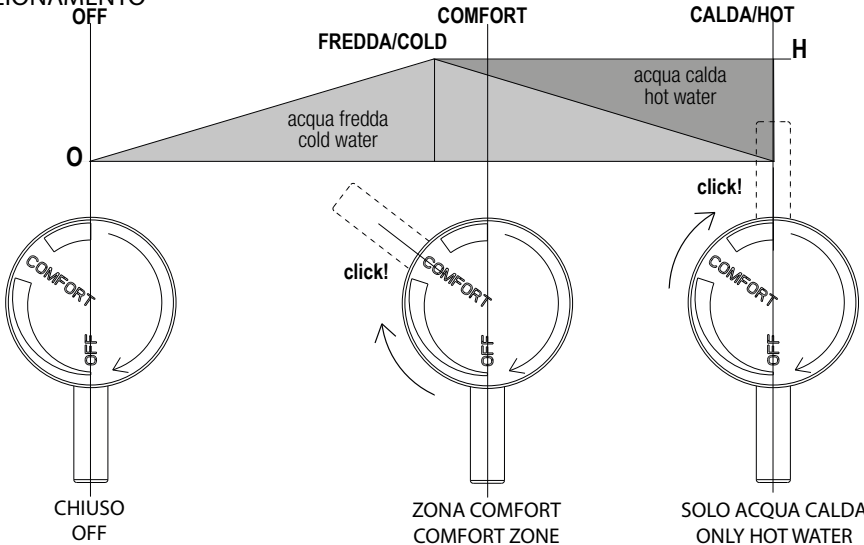

utilizzo corretto: dopo l'utilizzo riposizionare sempre la maniglia in posizione OFF
correct use: after use, always reposition the handle in OFF position.